

# MOSES LAKE CITY COUNCIL

Brent Reese  
Jason Avila  
Jon Lane

Bill Ecret  
Mayor



Joseph K. Gavinski  
City Manager

David Curnel  
Karen Liebrecht  
Dick Deane

July 24, 2012

## AGENDA

Sophia Guerrero, Executive Secretary

Civic Center - Council Chambers  
7:00 p.m.

1. Roll Call
2. Pledge of Allegiance
3. IDENTIFICATION OF CITIZENS WANTING TO DISCUSS AGENDA ITEMS  
IDENTIFICATION OF CITIZENS WANTING TO DISCUSS NON-AGENDA ITEMS
4. PRESENTATIONS AND AWARDS
  - A. Staff - Years of Service
  - B. Vision 2020
  - C. DOE Success Story International Paper/Larson Treatment Award
5. CONSENT AGENDA
  - A. Approval of Minutes - July 10, 2012
  - B. Approval of Bills and Checks Issued
  - C. Accept Work - Civic Center Parking Lot and Landscaping Project - 2011
6. COMMISSION APPOINTMENTS - None
7. CONSIDERATION OF BIDS AND QUOTES
  - A. Long Line Striper (Rebid)
  - B. Stratford Road Crosswalk Project - 2012
8. PETITIONS, COMMUNICATIONS, OR PUBLIC HEARINGS
  - A. Communication - POW/MIA Event - Progress Update - American Legion Post 209
  - B. Communication - Deferral/Deviation Requests - 631 Atlantic - Firouzi
9. ORDINANCES AND RESOLUTIONS
  - A. Ordinance - Amend MLMC Chapter 18.20 Residential Zone - Emergency Single Reading
  - B. Ordinance - Amend MLMC Chapter 18.58 Signs - 2<sup>nd</sup> Reading
  - C. Resolution - Petty Cash Change Fund - Increase
  - D. Resolution - Accept Donation of Funds for Park Bench in Memory of Myrna K. Corbett
10. REQUEST TO CALL FOR BIDS - None
11. REFERRALS FROM COMMISSIONS - None
12. OTHER ITEMS FOR COUNCIL CONSIDERATION
  - A. Request to Work Off Hours - Five Corners Improvement Project - 2012 -Neppel Electric
13. NON-AGENDA ITEMS AND PUBLIC QUESTIONS AND COMMENTS
14. COUNCIL QUESTIONS AND COMMENTS

Finance  
W. Robert  
Taylor

Municipal Services  
Gary Harer

Police Chief  
Dean Mitchell

Parks & Recreation  
Spencer Grigg

Fire Chief  
Tom Taylor

Community Development  
Gilbert Alvarado

City Attorney  
Katherine L.  
Kenison

15. **CITY MANAGER REPORTS AND COMMENTS**
- A. **2010 Chip Seal Repair Update**
  - B. **Staff Report**
    - 1. **Water/Sewer Rate and Charge Information**
    - 2. **Gambling Tax Income Report**
    - 3. **Investment Report**
    - 4. **Sales Tax Transient Rental Income Report**

<b>Finance</b> W. Robert Taylor	<b>Municipal Services</b> Gary Harer	<b>Police Chief</b> Dean Mitchell	<b>Parks &amp; Recreation</b> Spencer Grigg	<b>Fire Chief</b> Tom Taylor	<b>Community Development</b> Gilbert Alvarado	<b>City Attorney</b> Katherine L. Kenison
---------------------------------------	-----------------------------------------	--------------------------------------	------------------------------------------------	---------------------------------	--------------------------------------------------	-------------------------------------------------

MOSES LAKE CITY COUNCIL  
July 10, 2012

DRAFT

Council Present: Bill Ecret, Dick Deane, Karen Liebrecht, David Curnel, Brent Reese, Jason Avila, and Jon Lane

The meeting was called to order at 7 p.m. by Mayor Ecret.

PLEDGE OF ALLEGIANCE: Mr. Reese led the Council in the pledge of allegiance.

PRESENTATIONS AND AWARDS - None

CONSENT AGENDA

Minutes: The minutes of the June 26 meeting were presented for approval.

Approval of Claims, Prepaid Claims, Checks, and Payroll: Vouchers audited and certified by the Finance Director as required by RCW 42.24.080, and those expense reimbursement claims, certified as required by RCW 42.24.090, have been recorded on a listing which has been made available to the Council for approval and is retained for public inspection at the Civic Center. As of July 10, 2012 the Council does approve for payment claims in the amount of \$1,299,552.89; prepaid claims in the amounts of \$39,952.52, \$31,359.36, \$4,482.92, and \$14,169.64; claim checks in the amount of \$1,115,965.50; and payroll in the amounts of \$4,317.78 and \$378,081.67.

Accept Work - Civic Center Project: Team Construction has completed work on the Moses Lake Civic Center Project. The punch list has been completed and warranty items are being addressed. The work should be accepted and the 60 day lien period entered into.

International Paper Final Major Plat and Findings of Fact: International Paper submitted a final major plat of 17.96 acres located at 13594 Wheeler Road. The site is zoned Heavy Industrial and is consistent with the Comprehensive Plan Land Use Designation of Industrial. Findings of Fact were also presented for acceptance.

Six Year Street Transportation Improvement Program - Set Date for Public Hearing: A public hearing was set for August 14 to consider the Six Year Street Transportation Improvement Program.

Action Taken: Mr. Reese moved that the Consent Agenda be approved, seconded by Dr. Curnel, and passed unanimously.

COMMISSION APPOINTMENTS - None

CONSIDERATION OF BIDS AND QUOTES - None

PETITIONS, COMMUNICATIONS, OR PUBLIC HEARINGS - None

ORDINANCES AND RESOLUTIONS

RESOLUTION - ABANDON EASEMENT - BISNETT

A resolution was presented which abandons the 5' public utility easement on the east side of Lot 1, Block 3, Woodcrest Major Plat located at 613 Torrey Pines Drive.

The resolution authorizing abandonment of an easement was read by title only.

Gilbert Alvarado, Community Development Director, pointed out that when property is platted there is typically provided an easement along all property lines. The City does not allow any building in an easement. There are no utilities in the easement requested to be abandoned.

There was some discussion by the Council and staff was directed to proceed with abandoning the remainder of this easement in Block 3, Woodcrest Major Plat.

Action Taken: Mr. Lane moved that the resolution be adopted, seconded by Dr. Curnel, and passed unanimously.

#### RESOLUTION - BUILD ON UNPLATTED PROPERTY - MOSES LAKE INDUSTRIES

A resolution was presented which would allow Moses Lake Industries to construct a building at 8284 Randolph Road on unplatted property with the stipulation that the property be platted within one year.

The resolution allowing Moses Lake Industries to build on unplatted property was read by title only.

Gilbert Alvarado, Community Development Director, pointed out that the building to be constructed is a storage facility and will not require any city services. He mentioned that the cost of platting will exceed the cost of constructing the building.

Joseph K. Gavinski, City Manager, stated that the Council could allow the construction on unplatted property, without the requirement to plat within one year, since no additional utilities will be required and to be consistent with other decisions made under similar circumstances.

There was some discussion and it was pointed out that any further construction on the site would also trigger the requirement to plat and so the Council could again review the site and determine whether platting would be appropriate.

Action Taken: Mr. Deane moved that the resolution be amended to remove the requirement to plat within one year and the resolution be adopted, seconded by Mrs. Liebrecht, and passed unanimously.

#### REQUEST TO CALL FOR BIDS - None

#### REFERRALS FROM COMMISSIONS

#### MOSES LAKE SCHOOL DISTRICT APPEAL - FINDINGS OF FACT

The Community Development Department received an appeal with regard to the Planning Commission's decision to approve the Grant County Skill Center. The appeal was timely filed and considered complete. The Council, after considering the record established by the Planning Commission and the merits of the appeal, affirmed the decision of the Planning Commission to approve the Grant County Skill Center site plan and landscape plan. The Findings of Fact in support of the Council's decision were presented.

Action Taken: Mr. Lane moved that the Findings of Fact be approved, seconded by Dr. Curnel, and passed unanimously.

#### OTHER ITEMS FOR COUNCIL CONSIDERATION

#### WORK OFF HOURS - STREET DIVISION

The City's Street Division requested permission to start work at 4 a.m. to clean the catch basins, manholes, and mains in a portion of the downtown area. This will help complete the work when there is less traffic congestion. The late night work would be from July 23 to August 10.

Gary Harer, Municipal Services Director, stated that all residents within a block radius of the work will be notified of the late night work and provided with information on where to file any complaints.

Action Taken: Mr. Reese moved that the request to begin work early be granted, seconded by Mr. Avila, and passed unanimously.

#### REQUEST TO USE CITY PROPERTY - NATIONAL NIGHT OUT

The Police Department requested the use of Sinkiuse Square and the closure of Third Avenue from Beech Street to Ash Street on August 7 from 6 to 9 p.m. in honor of National Night Out. The Police employees plan to have a barbeque and live music at Sinkiuse Square and informational booths on Third Avenue.

Dean Mitchell, Police Chief, stated that National Night Out is designed to heighten awareness of crime prevention and to generate community support and participation in local anti-crime programs.

Action Taken: Mr. Reese moved that the request be granted, seconded by Mr. Avila, and passed unanimously.

NON-AGENDA ITEMS AND PUBLIC QUESTIONS AND COMMENTS - None

COUNCIL QUESTIONS AND COMMENTS - None

CITY MANAGER REPORTS AND COMMENTS

AUDIT REPORT

Joseph K. Gavinski, City Manager, stated that the State Auditors have completed their audit and the report is on the City's website. He mentioned that the auditors congratulated the City for having no findings over the past 10 years.

BUILDING ACTIVITY REPORT

The Building Activity Report for June was presented.

The regular meeting was adjourned at 7:50 p.m.

ATTEST

\_\_\_\_\_  
Bill J. Ecret, Mayor

\_\_\_\_\_  
W. Robert Taylor, Acting Finance Director

DATE 7/12/12  
TIME 14:39:14

PAGE 1  
XAPPRVD

CITY OF MOSES LAKE  
TABULATION OF CLAIMS TO BE APPROVED  
COUNCIL MEETING OF  
07/24/2012

NAME OF VENDOR	VENDOR NO	Expenditure Account		Purpose of Purchase
Department	Object Description	P.O. Number	P.O. Amount	
=====				
LOWES	00003886			
PARK RECREATION	OPERATING SUPPLIES	0000062761	97.09	MISC SUPPLIES
PARK RECREATION	REPAIR AND MAINTENANCE SUPPL	0000062761	35.82	MISC SUPPLIES
PARK RECREATION	REPAIR AND MAINTENANCE SUPPL	0000062761	1,684.16	MISC SUPPLIES
=====				
		TOTAL:	1,817.07	
UNITED PARCEL SERVICE	00005456			
ENGINEERING	POSTAGE	0000062776	132.38	SHIPPING CHARGES
=====				
		TOTAL:	132.38	
WESTERN DISPLAY FIREWORKS LTD	00005595			
MISC. SERVICES	PROFESSIONAL SERVICES	0000062760	16,000.00	FIREWORKS DISPLAY
=====				
		TOTAL:	16,000.00	
=====				
		REPORT TOTAL:	17,949.45	

DATE 7/12/12  
TIME 14:39:16

TOTALS PAGE  
XAPPRVD

CITY OF MOSES LAKE  
TABULATION OF CLAIMS TO BE APPROVED  
COUNCIL MEETING OF  
07/24/2012

TOTALS BY FUND

FUND NO	FUND NAME	AMOUNT
000	GENERAL FUND	17,949.45
	TOTAL	17,949.45

CHANGES TO BE MADE SHOULD BE LISTED BELOW

VEND NO.	P.O. NO.	AMT LISTED	CORRECTED AMT	ACTION TO BE TAKEN
.....	.....	.....	.....	.....
.....	.....	.....	.....	.....
.....	.....	.....	.....	.....

CORRECT AMOUNT TO BE PAID .....

\*\*\*\*\*  
\*  
\* C L A I M S A P P R O V A L \*  
\* WE, THE UNDERSIGNED COUNCILMEN OF THE CITY OF MOSES LAKE, WASHINGTON, DO HEREBY CERTIFY THAT THE MERCHANDISE \*  
\* OR SERVICES SPECIFIED HAVE BEEN RECEIVED AND THAT ABOVE CLAIMS ARE APPROVED, AS NOTED, FOR PAYMENT \*  
\* IN THE AMOUNT OF \$17,949.45 THIS 24TH DAY OF JULY, 2012 \*  
\* \*  
\* \*  
\* ..... \*  
\* COUNCIL MEMBER COUNCIL MEMBER \*  
\* \*  
\* \*  
\* ..... \*  
\* COUNCIL MEMBER FINANCE DIRECTOR \*  
\*\*\*\*\*

CITY OF MOSES LAKE  
TABULATION OF CLAIMS TO BE APPROVED  
COUNCIL MEETING OF  
07/24/2012

NAME OF VENDOR Department	VENDOR NO Object Description	Expenditure Account P.O. Number P.O. Amount		Purpose of Purchase
=====				
DATABAR	00007974			
WATER/BILLING	POSTAGE	0000062832	1,235.87	MAIL UTILITY BILLS
SEWER/BILLING	POSTAGE	0000062832	977.19	MAIL UTILITY BILLS
SANITATION FUND	POSTAGE	0000062832	549.24	MAIL UTILITY BILLS
STORM WATER	POSTAGE	0000062832	181.02	MAIL UTILITY BILLS
AMBULANCE SERVICE	POSTAGE	0000062832	151.00	MAIL UTILITY BILLS
=====				
		TOTAL:	3,094.32	
HOME DEPOT CREDIT SERVICES	00007824			
PARK RECREATION	OPERATING SUPPLIES	0000062854	100.82	MISC SUPPLIES
PARK RECREATION	REPAIR AND MAINTENANCE SUPPL	0000062854	59.27	MISC SUPPLIES
PARK RECREATION	REPAIR AND MAINTENANCE SUPPL	0000062854	115.94	MISC SUPPLIES
GRANTS AND DONATIONS	OPERATING SUPPLIES	0000062854	54.98	MISC SUPPLIES
STREET	REPAIR AND MAINTENANCE SUPPL	0000062854	25.86	MISC SUPPLIES
WATER	OPERATING SUPPLIES	0000062854	158.18	MISC SUPPLIES
SEWER	OPERATING SUPPLIES	0000062854	13.74	MISC SUPPLIES
BUILD MAINT-OPERATIO	REPAIR AND MAINTENANCE SUPPL	0000062854	11.19	MISC SUPPLIES
BUILD MAINT-OPERATIO	REPAIR AND MAINTENANCE SUPPL	0000062854	83.61	MISC SUPPLIES
BUILD MAINT-OPERATIO	REPAIR AND MAINTENANCE SUPPL	0000062854	350.53	MISC SUPPLIES
BUILD MAINT-OPERATIO	REPAIR AND MAINTENANCE SUPPL	0000062854	2.52	MISC SUPPLIES
BUILD MAINT-OPERATIO	REPAIR AND MAINTENANCE SUPPL	0000062854	142.22	MISC SUPPLIES
BUILD MAINT-OPERATIO	REPAIR AND MAINTENANCE SUPPL	0000062854	86.75	MISC SUPPLIES
=====				
		TOTAL:	1,205.61	
PUD OF GRANT COUNTY	00001501			
LIBRARY	UTILITY EXPENSE / ELECTRICIT	0000062834	623.68	ELECTRIC SERVICE
ENGINEERING	UTILITY EXPENSE / ELECTRICIT	0000062834	14.50	ELECTRIC SERVICE
PARK RECREATION	UTILITY EXPENSE / ELECTRICIT	0000062834	141.49	ELECTRIC SERVICE
PARK RECREATION	UTILITY EXPENSE / ELECTRICIT	0000062834	3,512.95	ELECTRIC SERVICE

CITY OF MOSES LAKE  
TABULATION OF CLAIMS TO BE APPROVED  
COUNCIL MEETING OF  
07/24/2012

NAME OF VENDOR Department	VENDOR NO Object Description	Expenditure Account		Purpose of Purchase
		P.O. Number	P.O. Amount	

PUD OF GRANT COUNTY	00001501			
PARK RECREATION	UTILITY EXPENSE / ELECTRICIT	0000062834	532.03	ELECTRIC SERVICE
PARK RECREATION	UTILITY EXPENSE / ELECTRICIT	0000062834	1,372.99	ELECTRIC SERVICE
PARK RECREATION	UTILITY EXPENSE / ELECTRICIT	0000062834	66.64	ELECTRIC SERVICE
PARK RECREATION	UTILITY EXPENSE / ELECTRICIT	0000062834	1,546.28	ELECTRIC SERVICE
PARK RECREATION	UTILITY EXPENSE / ELECTRICIT	0000062834	19.92	ELECTRIC SERVICE
PARK RECREATION	UTILITY EXPENSE / ELECTRICIT	0000062834	550.07	ELECTRIC SERVICE
PARK RECREATION	UTILITY EXPENSE / ELECTRICIT	0000062834	165.74	ELECTRIC SERVICE
POLICE	UTILITY EXPENSE / ELECTRICIT	0000062834	52.71	ELECTRIC SERVICE
POLICE	UTILITY EXPENSE / ELECTRICIT	0000062834	20.28	ELECTRIC SERVICE
FIRE	UTILITY EXPENSE / ELECTRICIT	0000062834	882.78	ELECTRIC SERVICE
PARKS/STREET	UTILITY EXPENSE / ELECTRICIT	0000062834	135.36	ELECTRIC SERVICE
STREET	UTILITY EXPENSE / ELECTRICIT	0000062834	751.49	ELECTRIC SERVICE
WATER	UTILITY EXPENSE / ELECTRICIT	0000062834	30,046.79	ELECTRIC SERVICE
SEWER	UTILITY EXPENSE / ELECTRICIT	0000062834	10,593.80	ELECTRIC SERVICE
AIRPORT	UTILITY EXPENSE / ELECTRICIT	0000062834	86.83	ELECTRIC SERVICE
BUILD MAINT-OPERATIO	UTILITY EXPENSE / ELECTRICIT	0000062834	1,330.32	ELECTRIC SERVICE
BUILD MAINT-OPERATIO	UTILITY EXPENSE / ELECTRICIT	0000062834	601.90	ELECTRIC SERVICE
BUILD MAINT-OPERATIO	UTILITY EXPENSE / ELECTRICIT	0000062834	1,091.29	ELECTRIC SERVICE
BUILD MAINT-OPERATIO	UTILITY EXPENSE / ELECTRICIT	0000062834	804.26	ELECTRIC SERVICE

=====

TOTAL: 54,944.10

STERLING SAVINGS BANK	00007077			
EXECUTIVE	OPERATING SUPPLIES	0000062825	65.92	T & S/SUPPLIES
EXECUTIVE	SMALL EQUIPMENT < \$1000	0000062825	508.42	T & S/SUPPLIES
EXECUTIVE	TRAVEL & SUBSISTENCE /NON-ED	0000062825	156.23	T & S/SUPPLIES
COMMUNITY DEVELOPMEN	PROFESSIONAL SERVICES	0000062827	7.55	MEMBERSHIP & MISC

CITY OF MOSES LAKE  
TABULATION OF CLAIMS TO BE APPROVED  
COUNCIL MEETING OF  
07/24/2012

NAME OF VENDOR Department	VENDOR NO Object Description	Expenditure Account		Purpose of Purchase
		P.O. Number	P.O. Amount	
STERLING SAVINGS BANK	00007077			
COMMUNITY DEVELOPMEN	OPERATING SUPPLIES	0000062827	23.10	MEMBERSHIP & MISC
COMMUNITY DEVELOPMEN	REGISTRATION & MEMBERSHIPS	0000062827	125.00	MEMBERSHIP & MISC
MISC. SERVICES	OPERATING SUPPLIES	0000062738	100.00	WELLNESS SUPPLIES
MISC. SERVICES	SMALL EQUIPMENT < \$1000	0000062738	454.15	WELLNESS SUPPLIES
MISC. SERVICES	OPERATING SUPPLIES	0000062826	30.90	COMPUTER SUPPLIES
ENGINEERING	TRAVEL & SUBSISTENCE /NON-ED	0000062818	15.15	SUPPLIES, T & S
PARK RECREATION	TRAVEL & SUBSISTENCE /NON-ED	0000062818	10.29	SUPPLIES, T & S
PARK RECREATION	OFFICE SUPPLIES	0000062865	254.26	LRC/LARSON/MAC RESALE/SUPPLIES
PARK RECREATION	OPERATING SUPPLIES	0000062865	89.51	LRC/LARSON/MAC RESALE/SUPPLIES
PARK RECREATION	OPERATING SUPPLIES	0000062865	20.76	LRC/LARSON/MAC RESALE/SUPPLIES
PARK RECREATION	OPERATING SUPPLIES	0000062865	6.73	LRC/LARSON/MAC RESALE/SUPPLIES
PARK RECREATION	OPERATING SUPPLIES	0000062865	559.72	LRC/LARSON/MAC RESALE/SUPPLIES
PARK RECREATION	OPERATING SUPPLIES	0000062865	40.76	LRC/LARSON/MAC RESALE/SUPPLIES
PARK RECREATION	POSTAGE	0000062865	5.90	LRC/LARSON/MAC RESALE/SUPPLIES
PARK RECREATION	OPERATING SUPPLIES	0000062865	786.78	LRC/LARSON/MAC RESALE/SUPPLIES
PARK RECREATION	S&S CONCESSION RESALE	0000062865	190.76	LRC/LARSON/MAC RESALE/SUPPLIES
PARK RECREATION	S&S CONCESSION RESALE	0000062865	393.03	LRC/LARSON/MAC RESALE/SUPPLIES
PARK RECREATION	OPERATING SUPPLIES	0000062865	657.05	LRC/LARSON/MAC RESALE/SUPPLIES
PARK RECREATION	OPERATING SUPPLIES	0000062865	36.62	LRC/LARSON/MAC RESALE/SUPPLIES
PARK RECREATION	REPAIR AND MAINTENANCE SUPPL	0000062865	479.41	LRC/LARSON/MAC RESALE/SUPPLIES
PARK RECREATION	TRAVEL & SUBSISTENCE /NON-ED	0000062865	20.04	LRC/LARSON/MAC RESALE/SUPPLIES
PARK RECREATION	REGISTRATION & MEMBERSHIPS	0000062865	360.00	LRC/LARSON/MAC RESALE/SUPPLIES
PARK RECREATION	OPERATING SUPPLIES	0000062865	74.58	LRC/LARSON/MAC RESALE/SUPPLIES
PARK RECREATION	LARSON RESALE	0000062865	277.57	LRC/LARSON/MAC RESALE/SUPPLIES

CITY OF MOSES LAKE  
TABULATION OF CLAIMS TO BE APPROVED  
COUNCIL MEETING OF  
07/24/2012

NAME OF VENDOR Department	VENDOR NO Object Description	Expenditure Account P.O. Number P.O. Amount		Purpose of Purchase
STERLING SAVINGS BANK	00007077			
PARK RECREATION	LAUZIER PLAYFIELD RESALE	0000062865	104.19	LRC/LARSON/MAC RESALE/SUPPLIES
PARK RECREATION	OPERATING SUPPLIES	0000062865	213.61	LRC/LARSON/MAC RESALE/SUPPLIES
PARK RECREATION	LARSON REC COMPLEX RESALE	0000062865	42.36	LRC/LARSON/MAC RESALE/SUPPLIES
POLICE	POSTAGE	0000062879	234.03	MISCELLANEOUS
POLICE	OPERATING SUPPLIES	0000062879	950.68	MISCELLANEOUS
POLICE	TRAVEL & SUBSISTENCE /NON-ED	0000062879	953.90	MISCELLANEOUS
FIRE	BOOKS /LESS \$100.00 TOTAL VA	0000062775	1,352.83	MISC SUPPLIES
FIRE	POSTAGE	0000062775	57.50	MISC SUPPLIES
FIRE	OPERATING SUPPLIES	0000062775	433.30	MISC SUPPLIES
GRANTS AND DONATIONS	OPERATING SUPPLIES	0000062865	1,433.87	LRC/LARSON/MAC RESALE/SUPPLIES
GRANTS AND DONATIONS	OPERATING SUPPLIES	0000062865	929.35	LRC/LARSON/MAC RESALE/SUPPLIES
PATHS & TRAILS	TRAVEL & SUBSISTENCE /NON-ED	0000062833	312.19	
PARKS/STREET	OPERATING SUPPLIES	0000062865	209.25	LRC/LARSON/MAC RESALE/SUPPLIES
STREET	TRAVEL & SUBSISTENCE /NON-ED	0000062818	10.29	SUPPLIES, T & S
WATER	TRAVEL & SUBSISTENCE /NON-ED	0000062818	15.16	SUPPLIES, T & S
AIRPORT	OPERATING SUPPLIES	0000062818	149.75	SUPPLIES, T & S
AMBULANCE SERVICE	OPERATING SUPPLIES	0000062775	579.25	MISC SUPPLIES
CENTRAL SERVICES	OPERATING SUPPLIES	0000062826	484.85	COMPUTER SUPPLIES
EQUIP RENTAL-OPERATI	OPERATING SUPPLIES	0000062775	9.70	MISC SUPPLIES
EQUIP RENTAL-OPERATI	GAS-PROPANE-FUEL	0000062879	354.78	MISCELLANEOUS
BUILD MAINT-OPERATIO	REPAIR AND MAINTENANCE SUPPL	0000062818	22.00	SUPPLIES, T & S
		=====		
		TOTAL:	14,603.03	
UNITED PARCEL SERVICE	00005456			
MISC. SERVICES	POSTAGE	0000062883	10.00	SHIPPING CHARGES

DATE 7/19/12  
TIME 13:55:21

PAGE 5  
XAPPRVD

CITY OF MOSES LAKE  
TABULATION OF CLAIMS TO BE APPROVED  
COUNCIL MEETING OF  
07/24/2012

NAME OF VENDOR	VENDOR NO	Expenditure Account		
Department	Object Description	P.O. Number	P.O. Amount	Purpose of Purchase
=====				
UNITED PARCEL SERVICE	00005456			
ENGINEERING	POSTAGE	0000062883	18.70	SHIPPING CHARGES
FIRE	POSTAGE	0000062883	65.20	SHIPPING CHARGES
WATER	POSTAGE	0000062883	6.48	SHIPPING CHARGES
			=====	
			TOTAL:	100.38
W S L C B	00005083			
GRANTS AND DONATIONS	OPERATING SUPPLIES	0000062820	60.00	SPECIAL OCCASION LICENSE
			=====	
			TOTAL:	60.00
			=====	
REPORT TOTAL:			74,007.44	

DATE 7/19/12  
TIME 13:55:23

TOTALS PAGE  
XAPPRVD

CITY OF MOSES LAKE  
TABULATION OF CLAIMS TO BE APPROVED  
COUNCIL MEETING OF  
07/24/2012

TOTALS BY FUND

FUND NO	FUND NAME	AMOUNT
000	GENERAL FUND	19,964.58
103	GRANTS AND DONATIONS	2,478.20
114	PATHS & TRAILS	312.19
116	STREET	1,132.25
410	WATER/SEWER	43,047.21
490	SANITATION FUND	549.24
493	STORM WATER	181.02
495	AIRPORT	236.58
498	AMBULANCE SERVICE FUND	730.25
517	CENTRAL SERVICES	484.85
519	EQUIPMENT RENTAL	364.48
528	BUILD MAINTENANCE	4,526.59
	TOTAL	74,007.44

CHANGES TO BE MADE SHOULD BE LISTED BELOW

VEND NO.	P.O. NO.	AMT LISTED	CORRECTED AMT	ACTION TO BE TAKEN
.....	.....	.....	.....	.....
.....	.....	.....	.....	.....
.....	.....	.....	.....	.....

CORRECT AMOUNT TO BE PAID .....

\*\*\*\*\*  
\* CLAIMS APPROVAL \*  
\* WE, THE UNDERSIGNED COUNCILMEN OF THE CITY OF MOSES LAKE, WASHINGTON, DO HEREBY CERTIFY THAT THE MERCHANDISE \*  
\* OR SERVICES SPECIFIED HAVE BEEN RECEIVED AND THAT ABOVE CLAIMS ARE APPROVED, AS NOTED, FOR PAYMENT \*  
\* IN THE AMOUNT OF \$74,007.44 THIS 24TH DAY OF JULY, 2012 \*  
\* \*  
\* \*  
\* ..... \*  
\* COUNCIL MEMBER COUNCIL MEMBER \*  
\* \*  
\* \*  
\* ..... \*  
\* COUNCIL MEMBER FINANCE DIRECTOR \*  
\*\*\*\*\*

DATE 7/20/12  
TIME 10:00:03

PAGE 1  
XAPPRVD

CITY OF MOSES LAKE  
TABULATION OF CLAIMS TO BE APPROVED  
COUNCIL MEETING OF  
07/24/2012

NAME OF VENDOR Department	VENDOR NO Object Description	Expenditure Account P.O. Number	P.O. Amount	Purpose of Purchase
3M COMPANY STREET	MCT1146 REPAIR AND MAINTENANCE SUPPL	00005022 0000062782	3,335.51	PEDESTRIAN SCHOOL SIGNS
			TOTAL:	3,335.51
ACTIVE NETWORK INC PARK RECREATION	00007606 PROFESSIONAL SERVICES	0000062748	809.25	CLASS MAINTENANCE (MAC)
			TOTAL:	809.25
AG WEST DISTRIBUTING CO INC PARK RECREATION	00006842 REPAIR AND MAINTENANCE SUPPL	0000062821	101.38	ROTARY TANK RISING NOZZLE
			TOTAL:	101.38
ALARM CENTER INC WATER SEWER	00005384 PROFESSIONAL SERVICES PROFESSIONAL SERVICES	0000062781 0000062781	36.75 36.75	MONITORING FEES MONITORING FEES
			TOTAL:	73.50
AQUATIC SPECIALTY SERVICES PARK RECREATION	00007861 OPERATING SUPPLIES	0000062864	1,111.92	POOL CHEMICALS
			TOTAL:	1,111.92
ASTRAL COMMUNICATIONS INC AMBULANCE SERVICE	00007414 MINOR EQUIPMENT < \$5000	0000062764	4,855.50	HOT SPOT EQUIP
			TOTAL:	4,855.50
BADGER METERS INC WATER	00000151 WATER METERS	0000062783	8,901.96	METER REPAIR MATERIAL
			TOTAL:	8,901.96
BASIN BARK PARK RECREATION	00006621 OPERATING SUPPLIES	0000062754	258.96	ALGAE FIX
			TOTAL:	258.96
BASIN LOCK & SECURITY PARK RECREATION POLICE POLICE	00003714 REPAIR & MAINT. OTHER (CONTR OPERATING SUPPLIES PROFESSIONAL SERVICES	0000062758 0000062877 0000062877	225.51 70.67 174.00	CELLULAR COMMUNICATOR/MAC MISCELLANEOUS MISCELLANEOUS
			TOTAL:	470.18
BASIN REFRIGERATION & HEAT INC WATER SEWER	00003512 REPAIR & MAINT. BUILDING (CO REPAIR & MAINT. BUILDING (CO	0000062730 0000062730	1,514.51 1,514.51	CONDENSER REPLACEMENT CONDENSER REPLACEMENT
			TOTAL:	3,029.02

CITY OF MOSES LAKE  
TABULATION OF CLAIMS TO BE APPROVED  
COUNCIL MEETING OF  
07/24/2012

NAME OF VENDOR Department	VENDOR NO Object Description	Expenditure Account P.O. Number P.O. Amount		Purpose of Purchase
=====				
BASIN SEPTIC SERVICES	00000166			
PARK RECREATION	REPAIR & MAINT. OTHER (CONTR	0000062728	161.85	SEPTIC SERVICES
=====				
		TOTAL:	161.85	
BLUMENTHAL UNIFORM CO INC	00000133			
POLICE	OPERATING SUPPLIES	0000062878	3,520.05	UNIFORMS
FIRE	OPERATING SUPPLIES	0000062857	198.37	UNIFORM SHIRTS
=====				
		TOTAL:	3,718.42	
BONNIE LONG	00007193			
PARK RECREATION	RENTAL/LEASE OTHER EQUIPMENT	0000062739	100.00	VEHICLE USE - JULY
=====				
		TOTAL:	100.00	
BURKE MARKETING & PROMOTION	00005798			
TOURISM ACTIVITIES	PROFESSIONAL SERVICES	0000062745	36,500.00	SUMMER CONCERTS/EVENTS
TOURISM ACTIVITIES	OPERATING SUPPLIES	0000062882	1,878.31	ADVERTISING SNS/CONCERT/KIOSKS
TOURISM ACTIVITIES	PROFESSIONAL SERVICES	0000062882	2,000.00	ADVERTISING SNS/CONCERT/KIOSKS
TOURISM ACTIVITIES	ADVERTISING	0000062882	35,183.77	ADVERTISING SNS/CONCERT/KIOSKS
TOURISM ACTIVITIES	ADVERTISING	0000062882	9,593.28	ADVERTISING SNS/CONCERT/KIOSKS
=====				
		TOTAL:	85,155.36	
BUSINESS INTERIORS & EQUIPMENT	00003619			
SEWER/BILLING	SMALL EQUIPMENT < \$1000	0000062842	334.48	KEYBOARD TRAYS, CHAIR
CIVIC CENTER	MINOR EQUIPMENT < \$5000	0000062842	556.76	KEYBOARD TRAYS, CHAIR
=====				
		TOTAL:	891.24	
CARTEGRAPH SYSTEMS INC	00005700			
WATER	PROFESSIONAL SERVICES	0000062861	125.00	IMPLEMENTATION SERVICES
SEWER	PROFESSIONAL SERVICES	0000062861	125.00	IMPLEMENTATION SERVICES
STORM WATER	PROFESSIONAL SERVICES	0000062861	125.00	IMPLEMENTATION SERVICES
=====				
		TOTAL:	375.00	
CASCADE DIESEL INC	00003551			
EQUIP RENTAL-OPERATI	REPAIR & MAINT. EQUIP. (CONT	0000062790	499.98	REPAIR A/C
=====				
		TOTAL:	499.98	
CASCADE NATURAL GAS CORP	00000203			
PARK RECREATION	UTILITY EXPENSE / GAS	0000062852	11,587.46	LRC/AQC GAS USAGE
PARK RECREATION	UTILITY EXPENSE / GAS	0000062852	10.60	LRC/AQC GAS USAGE

CITY OF MOSES LAKE  
TABULATION OF CLAIMS TO BE APPROVED  
COUNCIL MEETING OF  
07/24/2012

NAME OF VENDOR Department	VENDOR NO Object Description	Expenditure Account P.O. Number P.O. Amount		Purpose of Purchase
=====				
CASCADE NATURAL GAS CORP	00000203			
FIRE	UTILITY EXPENSE / GAS	0000062837	126.03	NAT GAS SERVICE
BUILD MAINT-OPERATIO	UTILITY EXPENSE / GAS	0000062837	35.21	NAT GAS SERVICE
		=====		
		TOTAL:	11,759.30	
CEDAR STREET CLEANERS	00004655			
POLICE	OPERATING SUPPLIES	0000062872	594.72	UNIFORM MAINTENANCE
FIRE	OPERATING SUPPLIES	0000062769	27.78	UNIFORM MAINT
		=====		
		TOTAL:	622.50	
CENTRAL MACHINERY SALES INC	00002779			
WATER	OPERATING SUPPLIES	0000062791	146.98	GUTTER BROOMS, FORMS
EQUIP RENTAL-OPERATI	REPAIR AND MAINTENANCE SUPPL	0000062791	243.75	GUTTER BROOMS, FORMS
		=====		
		TOTAL:	390.73	
CENTRAL WASHINGTON EXCAVATION	00004279			
SEWER	REPAIR & MAINT. OTHER (CONTR	0000062787	3,129.10	ASPHALT PATCH
		=====		
		TOTAL:	3,129.10	
CERTIFIED LABORATORIES	00006099			
WATER	OPERATING SUPPLIES	0000062784	212.56	ADHESIVE SEALANT
		=====		
		TOTAL:	212.56	
CHAMBER OF COMMERCE	00002627			
POLICE	TRAVEL & SUBSISTENCE /NON-ED	0000062874	100.00	MEALS
		=====		
		TOTAL:	100.00	
CHASE PAYMENTECH-EFT	00004046			
WATER/BILLING	BANK CHARGES	0000062840	645.09	CREDIT CARD FEES
SEWER/BILLING	BANK CHARGES	0000062840	645.09	CREDIT CARD FEES
SANITATION FUND	BANK CHARGES	0000062840	645.09	CREDIT CARD FEES
		=====		
		TOTAL:	1,935.27	
CHS INC	00000249			
EQUIP RENTAL-OPERATI	GAS-PROPANE-FUEL	0000062786	33,835.47	FUEL FOR VEHICLES
		=====		
		TOTAL:	33,835.47	
CITY OF MOSES LAKE	00008106			
WATER	REPAIR & MAINT. BUILDING (CO	0000062731	79.72	RETAINAGE/BASIN REFRIG/COND
SEWER	REPAIR & MAINT. BUILDING (CO	0000062731	79.71	RETAINAGE/BASIN REFRIG/COND
WATER SEWER CONSTRUC	CIP-SEWER PROJECTS	0000062830	2,060.85	RETAIN PE1 WLLM CHRLS W DIV ST

CITY OF MOSES LAKE  
TABULATION OF CLAIMS TO BE APPROVED  
COUNCIL MEETING OF  
07/24/2012

NAME OF VENDOR Department	VENDOR NO Object Description	Expenditure Account P.O. Number P.O. Amount		Purpose of Purchase
=====				
CITY OF MOSES LAKE	00008106			
WATER SEWER CONSTRUC	CIP-SEWER PROJECTS	0000062881	7,459.28	RETAIN FINL INLND NW ELEC TLMT
=====				
		TOTAL:	9,679.56	
=====				
	00008107			
BUILD MAINT-OPERATIO	INTEREST ON INTERFUND DEBT	0000062831	80,000.00	REPAY INTERFUND LOAN
=====				
		TOTAL:	80,000.00	
=====				
	00008201			
LIBRARY	UTILITY EXPENSE / W-S-G	0000062849	301.14	WATER SERVICE
PARK RECREATION	UTILITY EXPENSE / W-S-G	0000062849	704.09	WATER SERVICE
PARK RECREATION	UTILITY EXPENSE / W-S-G	0000062849	1,328.86	WATER SERVICE
PARK RECREATION	UTILITY EXPENSE / W-S-G	0000062849	9,435.31	WATER SERVICE
PARK RECREATION	UTILITY EXPENSE / W-S-G	0000062849	932.73	WATER SERVICE
PARK RECREATION	UTILITY EXPENSE / W-S-G	0000062849	1,691.17	WATER SERVICE
PARK RECREATION	UTILITY EXPENSE / W-S-G	0000062849	544.11	WATER SERVICE
PARK RECREATION	UTILITY EXPENSE / W-S-G	0000062849	435.57	WATER SERVICE
PARK RECREATION	UTILITY EXPENSE / W-S-G	0000062849	2,556.87	WATER SERVICE
PARK RECREATION	UTILITY EXPENSE / W-S-G	0000062849	199.47	WATER SERVICE
PARK RECREATION	UTILITY EXPENSE / W-S-G	0000062849	255.45	WATER SERVICE
PARK RECREATION	UTILITY EXPENSE / W-S-G	0000062849	382.77	WATER SERVICE
PARK RECREATION	UTILITY EXPENSE / W-S-G	0000062849	1,712.86	WATER SERVICE
PARK RECREATION	UTILITY EXPENSE / W-S-G	0000062849	115.54	WATER SERVICE
PARK RECREATION	UTILITY EXPENSE / W-S-G	0000062855	835.00	WATER SERVICE
PARKS/STREET	UTILITY EXPENSE / W-S-G	0000062849	116.34	WATER SERVICE
PARKS/STREET	UTILITY EXPENSE / W-S-G	0000062849	188.96	WATER SERVICE
PARKS/STREET	UTILITY EXPENSE / W-S-G	0000062849	4,704.51	WATER SERVICE
PARKS/STREET	UTILITY EXPENSE / W-S-G	0000062849	1,963.09	WATER SERVICE
PARKS/STREET	UTILITY EXPENSE / W-S-G	0000062849	85.73	WATER SERVICE

CITY OF MOSES LAKE  
TABULATION OF CLAIMS TO BE APPROVED  
COUNCIL MEETING OF  
07/24/2012

NAME OF VENDOR Department	VENDOR NO Object Description	Expenditure Account P.O. Number P.O. Amount		Purpose of Purchase
=====				
CITY OF MOSES LAKE	00008201			
SEWER	UTILITY EXPENSE / W-S-G	0000062855	5,270.90	WATER SERVICE
STORM WATER	LANDFILL DUMPING FEES	0000062849	1,812.00	WATER SERVICE
AIRPORT	UTILITY EXPENSE / W-S-G	0000062849	438.18	WATER SERVICE
BUILD MAINT-OPERATIO	UTILITY EXPENSE / W-S-G	0000062849	267.74	WATER SERVICE
BUILD MAINT-OPERATIO	UTILITY EXPENSE / W-S-G	0000062849	827.87	WATER SERVICE
BUILD MAINT-OPERATIO	UTILITY EXPENSE / W-S-G	0000062849	389.70	WATER SERVICE
BUILD MAINT-OPERATIO	UTILITY EXPENSE / W-S-G	0000062849	327.16	WATER SERVICE
BUILD MAINT-OPERATIO	UTILITY EXPENSE / W-S-G	0000062849	435.04	WATER SERVICE
BUILD MAINT-OPERATIO	UTILITY EXPENSE / W-S-G	0000062849	111.96	WATER SERVICE
BUILD MAINT-OPERATIO	UTILITY EXPENSE / W-S-G	0000062849	92.72	WATER SERVICE
BUILD MAINT-OPERATIO	UTILITY EXPENSE / W-S-G	0000062855	199.53	WATER SERVICE
		=====		
		TOTAL:	38,662.37	
CITY OF SPOKANE	00004155			
POLICE	PROFESSIONAL SERVICES	0000062873	33.00	EVIDENCE DESTRUCTION
		=====		
		TOTAL:	33.00	
COLUMBIA BASIN DAILY HERALD	00000210			
PARK RECREATION	ADVERTISING	0000062741	228.10	RECREATION PROGRAM ADVERTISING
PARK RECREATION	ADVERTISING	0000062741	228.10	RECREATION PROGRAM ADVERTISING
POLICE	ADVERTISING	0000062871	40.00	ADVERTISING
FIRE	ADVERTISING	0000062765	40.00	ADVERTISING
		=====		
		TOTAL:	536.20	
COLUMBIA BASIN MACHINE	00000211			
STORM WATER	REPAIR & MAINT. EQUIP. (CONT	0000062788	118.69	WELD FITTING
		=====		
		TOTAL:	118.69	
COLUMBIA BEARING SALES	00000274			
SEWER	REPAIR AND MAINTENANCE SUPPL	0000062785	429.86	BELTS
		=====		
		TOTAL:	429.86	
COLUMBIA PAINT & COATINGS	00005279			

CITY OF MOSES LAKE  
TABULATION OF CLAIMS TO BE APPROVED  
COUNCIL MEETING OF  
07/24/2012

NAME OF VENDOR Department	VENDOR NO Object Description	Expenditure Account P.O. Number	P.O. Amount	Purpose of Purchase
STREET	REPAIR AND MAINTENANCE SUPPL	0000062793	50.98	PAINT, SUPPLIES
SEWER	OPERATING SUPPLIES	0000062793	346.80	PAINT, SUPPLIES
			=====	
TOTAL:			397.78	
COMFORT SUITES	00007678			
TOURISM ACTIVITIES	OPERATING SUPPLIES	0000062868	1,585.61	ROOMS FOR CONCERT PERFORMERS
			=====	
TOTAL:			1,585.61	
COMMERCIAL TIRE	00005968			
EQUIP RENTAL-OPERATI	REPAIR & MAINT. EQUIP. (CONT	0000062794	1,567.87	TIRE REPAIRS
			=====	
TOTAL:			1,567.87	
CONCESSIONS SUPPLY	00006286			
PARK RECREATION	S&S CONCESSION RESALE	0000062752	39.47	LRC/LAUZIER RESALE/MAINTENANCE
PARK RECREATION	REPAIR & MAINT. OTHER (CONTR	0000062752	504.55	LRC/LAUZIER RESALE/MAINTENANCE
PARK RECREATION	LARSON RESALE	0000062752	186.37	LRC/LAUZIER RESALE/MAINTENANCE
PARK RECREATION	LAUZIER PLAYFIELD RESALE	0000062752	244.98	LRC/LAUZIER RESALE/MAINTENANCE
PARK RECREATION	LARSON REC COMPLEX RESALE	0000062752	85.97	LRC/LAUZIER RESALE/MAINTENANCE
			=====	
TOTAL:			1,061.34	
CONSOLIDATED ELECTRIC DIST	00000819			
PARK RECREATION	OPERATING SUPPLIES	0000062726	192.51	MISC SUPPLIES
PARK RECREATION	REPAIR AND MAINTENANCE SUPPL	0000062726	10.63	MISC SUPPLIES
WATER	OPERATING SUPPLIES	0000062792	26.22	BATTERIES, BALLASTS
BUILD MAINT-OPERATIO	REPAIR AND MAINTENANCE SUPPL	0000062792	57.80	BATTERIES, BALLASTS
BUILD MAINT-OPERATIO	REPAIR AND MAINTENANCE SUPPL	0000062792	177.69	BATTERIES, BALLASTS
			=====	
TOTAL:			464.85	
COST LESS CARPET	00005143			
PARK RECREATION	REPAIR AND MAINTENANCE SUPPL	0000062755	19.04	BOND MEMORY W/SPILL GUARD
			=====	
TOTAL:			19.04	
CWSS/PNWS AWWA	00005447			
ENGINEERING	REGISTRATION & MEMBERSHIPS	0000062780	30.00	REGIS/METER SIZING
WATER	REGISTRATION & MEMBERSHIPS	0000062780	50.00	REGIS/METER SIZING
			=====	
TOTAL:			80.00	
DB SECURE SHRED	00003144			

CITY OF MOSES LAKE  
TABULATION OF CLAIMS TO BE APPROVED  
COUNCIL MEETING OF  
07/24/2012

NAME OF VENDOR Department	VENDOR NO Object Description	Expenditure Account		Purpose of Purchase
		P.O. Number	P.O. Amount	
EXECUTIVE	PROFESSIONAL SERVICES	0000062829	6.77	RECORDS DESTRUCTION
FINANCE	PROFESSIONAL SERVICES	0000062829	6.78	RECORDS DESTRUCTION
POLICE	PROFESSIONAL SERVICES	0000062829	13.55	RECORDS DESTRUCTION
FIRE	PROFESSIONAL SERVICES	0000062829	13.55	RECORDS DESTRUCTION
WATER	PROFESSIONAL SERVICES	0000062829	13.55	RECORDS DESTRUCTION
WATER/BILLING	PROFESSIONAL SERVICES	0000062829	4.51	RECORDS DESTRUCTION
SEWER/BILLING	PROFESSIONAL SERVICES	0000062829	4.52	RECORDS DESTRUCTION
SANITATION FUND	PROFESSIONAL SERVICES	0000062829	4.52	RECORDS DESTRUCTION
		=====		
		TOTAL:	67.75	
DESERT GRAPHICS INC	00006564			
PARK RECREATION	OPERATING SUPPLIES	0000062746	600.01	MAINTENANCE SHIRTS
		=====		
		TOTAL:	600.01	
DISCOVERY FORD LM HONDA	00001207			
EQUIP RENTAL-OPERATI	OIL, LUBRICANTS & DEISEL EX	0000062796	267.37	BEARING, OIL
EQUIP RENTAL-OPERATI	REPAIR AND MAINTENANCE SUPPL	0000062796	87.26	BEARING, OIL
		=====		
		TOTAL:	354.63	
DR LOU SOWERS	00001856			
POLICE	PROFESSIONAL SERVICES	0000062876	450.00	PSYCHOLOGICAL
		=====		
		TOTAL:	450.00	
EASTERN CASCADE DIST	00006909			
POLICE	OPERATING SUPPLIES	0000062875	33.00	DRINKING WATER
		=====		
		TOTAL:	33.00	
ELVIS SWISHER	00002623			
FIREMANS PENSION	DIRECT MEDICAL PAYMENTS	0000062844	1,115.00	BAL/REPLACEMENT OF TOOTH
		=====		
		TOTAL:	1,115.00	
ENVIRO CLEAN EQUIP INC	00007655			
EQUIP RENTAL-OPERATI	REPAIR AND MAINTENANCE SUPPL	0000062797	817.69	FILTER, ELEMENT
		=====		
		TOTAL:	817.69	
FABER INDUSTRIAL SUPPLY	00000501			
PARK RECREATION	SMALL EQUIPMENT < \$1000	0000062610	60.69	MISC SUPPLIES
PARK RECREATION	REPAIR AND MAINTENANCE SUPPL	0000062610	43.70	MISC SUPPLIES

CITY OF MOSES LAKE  
TABULATION OF CLAIMS TO BE APPROVED  
COUNCIL MEETING OF  
07/24/2012

NAME OF VENDOR Department	VENDOR NO Object Description	Expenditure Account P.O. Number P.O. Amount		Purpose of Purchase
STREET	REPAIR AND MAINTENANCE SUPPL	0000062798	41.28	MISC SUPPLIES
STREET	SMALL EQUIPMENT < \$1000	0000062798	236.57	MISC SUPPLIES
WATER	REPAIR AND MAINTENANCE SUPPL	0000062798	27.47	MISC SUPPLIES
EQUIP RENTAL-OPERATI	REPAIR AND MAINTENANCE SUPPL	0000062798	7.07	MISC SUPPLIES
		TOTAL:		416.78
FASTENAL COMPANY	00007372			
WATER	OPERATING SUPPLIES	0000062799	292.56	MISC SUPPLIES
BUILD MAINT-OPERATIO	OPERATING SUPPLIES	0000062799	28.03	MISC SUPPLIES
		TOTAL:		320.59
FBI-LEEDA	00006668			
POLICE	REGISTRATION & MEMBERSHIPS	0000062869	50.00	MEMBERSHIP
		TOTAL:		50.00
FOOD SERVICES OF AMERICA	00007168			
PARK RECREATION	OPERATING SUPPLIES	0000062867	79.86	LRC/SNS RESALE/SUPPLIES
PARK RECREATION	S&S CONCESSION RESALE	0000062867	5,623.91	LRC/SNS RESALE/SUPPLIES
PARK RECREATION	OPERATING SUPPLIES	0000062867	33.24	LRC/SNS RESALE/SUPPLIES
PARK RECREATION	LARSON RESALE	0000062867	1,465.48	LRC/SNS RESALE/SUPPLIES
PARK RECREATION	LAUZIER PLAYFIELD RESALE	0000062867	431.95	LRC/SNS RESALE/SUPPLIES
PARK RECREATION	LARSON REC COMPLEX RESALE	0000062867	133.98	LRC/SNS RESALE/SUPPLIES
		TOTAL:		7,768.42
FREDERICK HAYNES	00000730			
POLICE	DIRECT MEDICAL PAYMENTS	0000062846	58.36	PRESC CO-PAY
FIREMANS PENSION	DIRECT MEDICAL PAYMENTS	0000062847	334.00	PRESC CO-PAY
		TOTAL:		392.36
GARRY OTTMAR	00004434			
PARK RECREATION	MISCELLANEOUS (NOT LISTED BE	0000062807	7.50	MISC DUMPING
WATER	MISCELLANEOUS (NOT LISTED BE	0000062807	117.00	MISC DUMPING
		TOTAL:		124.50
GEMPLERS INC	00000609			
PARK RECREATION	OPERATING SUPPLIES	0000062862	818.97	12-MONTH SHIPPING SAVER

CITY OF MOSES LAKE  
TABULATION OF CLAIMS TO BE APPROVED  
COUNCIL MEETING OF  
07/24/2012

NAME OF VENDOR Department	VENDOR NO Object Description	Expenditure Account P.O. Number P.O. Amount		Purpose of Purchase
=====				
		TOTAL:	818.97	
GENERAL PACIFIC	00004937			
WATER	REPAIR AND MAINTENANCE SUPPL	0000062800	12,353.46	STORZ CONNECTIONS
=====				
		TOTAL:	12,353.46	
GLOBAL EQUIPMENT COMPANY	00005130			
EXECUTIVE	OPERATING SUPPLIES	0000062772	71.23	COFFEE CARAFES
=====				
		TOTAL:	71.23	
GRAINGER PARTS OPERATIONS	00002755			
BUILD MAINT-OPERATIO	OPERATING SUPPLIES	0000062801	637.10	MISC SUPPLIES
BUILD MAINT-OPERATIO	OPERATING SUPPLIES	0000062801	402.70	MISC SUPPLIES
BUILD MAINT-OPERATIO	OPERATING SUPPLIES	0000062801	323.67	MISC SUPPLIES
BUILD MAINT-OPERATIO	REPAIR AND MAINTENANCE SUPPL	0000062801	27.60	MISC SUPPLIES
=====				
		TOTAL:	1,391.07	
GRANT CO SOLID WASTE DEPT	00000640			
SANITATION FUND	LANDFILL DUMPING FEES	0000062828	20,638.73	LANDFILL DUMPING FEES
=====				
		TOTAL:	20,638.73	
GRANT COUNTY ECON DEV COUNCIL	00005738			
LEGISLATIVE	TRAVEL & SUBSISTENCE /NON-ED	0000062774	18.00	ASSN OF WA BUS LUNCHEON
=====				
		TOTAL:	18.00	
GRANT COUNTY FIRE DIST NO 5	00003502			
FIRE	REGISTRATION & MEMBERSHIPS	0000062770	900.00	REGIS/INSTRUCTOR CLASS
=====				
		TOTAL:	900.00	
HARRIS COMPUTERS	00005872			
CENTRAL SERVICES	PROFESSIONAL SERVICES	0000062856	500.00	SOFTWARE MAINTENANCE
=====				
		TOTAL:	500.00	
HELENA CHEMICAL COMPANY	00006809			
PARK RECREATION	OPERATING SUPPLIES	0000062544	870.90	HONCHO PLUS/WEEDMASTER
PARKS/STREET	OPERATING SUPPLIES	0000062756	54.90	HONCHO PLUS
WATER	OPERATING SUPPLIES	0000062756	457.64	HONCHO PLUS
SEWER	OPERATING SUPPLIES	0000062756	486.76	HONCHO PLUS
=====				
		TOTAL:	1,870.20	

DATE 7/20/12  
TIME 10:00:03

PAGE 10  
XAPPRVD

CITY OF MOSES LAKE  
TABULATION OF CLAIMS TO BE APPROVED  
COUNCIL MEETING OF  
07/24/2012

NAME OF VENDOR	VENDOR NO	Expenditure Account		
Department	Object Description	P.O. Number	P.O. Amount	Purpose of Purchase
=====				
INLAND NORTHWEST ELECTRIC	00003634			
WATER SEWER CONSTRUC	CIP-SEWER PROJECTS	0000062880	153,512.00	PE 2 FINAL WSTEWTR TLMTRY 12
=====				
		TOTAL:	153,512.00	
JERRYS AUTO SUPPLY	00005835			
PARK RECREATION	REPAIR AND MAINTENANCE SUPPL	0000062753	711.05	MISC. SUPPLIES
EQUIP RENTAL-OPERATI	REPAIR AND MAINTENANCE SUPPL	0000062802	146.17	MISC REPAIR SUPPLIES
=====				
		TOTAL:	857.22	
KIMBALL MIDWEST	00005360			
EQUIP RENTAL-OPERATI	REPAIR AND MAINTENANCE SUPPL	0000062803	129.32	REPAIR SUPPLIES
=====				
		TOTAL:	129.32	
KIMMEL ATHLETIC SUPPLY	00003462			
PARK RECREATION	OPERATING SUPPLIES	0000062744	494.43	SOFTBALLS
PARK RECREATION	OPERATING SUPPLIES	0000062744	494.42	SOFTBALLS
=====				
		TOTAL:	988.85	
LINCOLN EQUIPMENT INC	00006292			
PARK RECREATION	REPAIR AND MAINTENANCE SUPPL	0000062863	563.24	FIBERGLASS POLE/COUPLER
=====				
		TOTAL:	563.24	
LOCALTEL COMMUNICATIONS	00004374			
CENTRAL SERVICES	PROFESSIONAL SERVICES	0000062835	1,808.10	INTERNET SERVICE
=====				
		TOTAL:	1,808.10	
MERCHANT SOLUTIONS - EFT	00005882			
COMMUNITY DEVELOPMEN	BANK CHARGES	0000062841	474.62	CREDIT CARD FEES
ENGINEERING	BANK CHARGES	0000062841	526.46	CREDIT CARD FEES
PARK RECREATION	BANK CHARGES	0000062841	72.92	CREDIT CARD FEES
PARK RECREATION	BANK CHARGES	0000062841	1,274.78	CREDIT CARD FEES
PARK RECREATION	BANK CHARGES	0000062841	645.09	CREDIT CARD FEES
PARK RECREATION	BANK CHARGES	0000062841	30.12	CREDIT CARD FEES
POLICE	BANK CHARGES	0000062841	35.35	CREDIT CARD FEES
FIRE	BANK CHARGES	0000062841	15.74	CREDIT CARD FEES
WATER/BILLING	BANK CHARGES	0000062841	38.71	CREDIT CARD FEES
SEWER/BILLING	BANK CHARGES	0000062841	38.71	CREDIT CARD FEES

DATE 7/20/12  
TIME 10:00:03

PAGE 11  
XAPPRVD

CITY OF MOSES LAKE  
TABULATION OF CLAIMS TO BE APPROVED  
COUNCIL MEETING OF  
07/24/2012

NAME OF VENDOR	VENDOR NO	Expenditure Account		
Department	Object Description	P.O. Number	P.O. Amount	Purpose of Purchase
=====				
MERCHANT SOLUTIONS - EFT	00005882			
SANITATION FUND	BANK CHARGES	0000062841	38.71	CREDIT CARD FEES
=====				
		TOTAL:	3,191.21	
MLHS BASEBALL BOOSTERS	00006324			
PARK RECREATION	PROFESSIONAL SERVICES	0000062789	3,648.00	BASEBALL CAMP INSTRUCTION
=====				
		TOTAL:	3,648.00	
MOSES LAKE SOCCER TOTS	00007063			
PARK RECREATION	PROFESSIONAL SERVICES	0000062747	288.00	SOCCER TOTS CAMP INSTRUCTION
=====				
		TOTAL:	288.00	
MOSES LAKE STEEL SUPPLY	00001268			
PARK RECREATION	OPERATING SUPPLIES	0000062619	2,119.71	MISC SUPPLIES
PARK RECREATION	OPERATING SUPPLIES	0000062619	1,395.02	MISC SUPPLIES
PARK RECREATION	REPAIR AND MAINTENANCE SUPPL	0000062619	8.53	MISC SUPPLIES
FIRE	OPERATING SUPPLIES	0000062763	122.06	MISC SUPPLIES
STREET	REPAIR AND MAINTENANCE SUPPL	0000062804	11.23	PIPE AND REPAIR SUPPLIES
WATER	REPAIR AND MAINTENANCE SUPPL	0000062804	3,325.44	PIPE AND REPAIR SUPPLIES
=====				
		TOTAL:	6,981.99	
MYRON PALMER	00006605			
POLICE	DIRECT MEDICAL PAYMENTS	0000062845	85.99	PRESC CO-PAY
=====				
		TOTAL:	85.99	
NORCO ENTERPRISES INC	00006590			
PARK RECREATION	OPERATING SUPPLIES	0000062779	1,075.35	WELDER/CYLINDER/SUPPLIES
PARK RECREATION	SMALL EQUIPMENT < \$1000	0000062779	748.83	WELDER/CYLINDER/SUPPLIES
WATER	REPAIR AND MAINTENANCE SUPPL	0000062805	12.14	CUTTING TIP
AMBULANCE SERVICE	OPERATING SUPPLIES	0000062762	266.53	MEDICAL OXYGEN
=====				
		TOTAL:	2,102.85	
OASIS AUTO SPA	00004834			
EQUIP RENTAL-OPERATI	REPAIR & MAINT. EQUIP. (CONT	0000062806	318.00	CAR WASHES
=====				
		TOTAL:	318.00	
OXARC INC	00001412			
PARK RECREATION	OPERATING SUPPLIES	0000062621	544.94	MISC SUPPLIES
PARK RECREATION	OPERATING SUPPLIES	0000062621	35.18	MISC SUPPLIES

CITY OF MOSES LAKE  
TABULATION OF CLAIMS TO BE APPROVED  
COUNCIL MEETING OF  
07/24/2012

NAME OF VENDOR	VENDOR NO	Expenditure Account		Purpose of Purchase
Department	Object Description	P.O. Number	P.O. Amount	
OXARC INC	00001412			
PARKS/STREET	OPERATING SUPPLIES	0000062621	64.48	MISC SUPPLIES
SEWER	OPERATING SUPPLIES	0000062808	102.19	ORANGE T-SHIRTS
		=====		
		TOTAL:	746.79	
PARAMOUNT SUPPLY COMPANY	00006725			
BUILD MAINT-OPERATIO	OPERATING SUPPLIES	0000062809	452.37	AIRGUARD
		=====		
		TOTAL:	452.37	
PERFECTION TIRE & AUTOMOTIVE	00004609			
EQUIP RENTAL-OPERATI	REPAIR & MAINT. EQUIP. (CONT	0000062810	48.67	BALANCE TIRES
		=====		
		TOTAL:	48.67	
PROGRESSIVE MEDICAL INTL	00006656			
AMBULANCE SERVICE	OPERATING SUPPLIES	0000062860	1,087.84	AMBULANCE SUPPLIES
		=====		
		TOTAL:	1,087.84	
PROVIDENCE SACRED HEART CTR	00007664			
AMBULANCE SERVICE	REPAIR & MAINT. EQUIP. (CONT	0000062767	469.37	REPAIR DEFIBRILLATOR
		=====		
		TOTAL:	469.37	
PUBLIC SAFETY TESTING	00005085			
POLICE	REGISTRATION & MEMBERSHIPS	0000062823	400.00	SUBSCRIPTION FEES
FIRE	REGISTRATION & MEMBERSHIPS	0000062823	350.00	SUBSCRIPTION FEES
		=====		
		TOTAL:	750.00	
PUD OF GRANT COUNTY	00001501			
PARK RECREATION	UTILITY EXPENSE / ELECTRICIT	0000062848	1,381.10	ELEC SERVICE/ST LIGHTS
STREET	UTILITY EXPENSE / ELECTRICIT	0000062848	34,483.16	ELEC SERVICE/ST LIGHTS
		=====		
		TOTAL:	35,864.26	
QUILL CORPORATION	00004811			
MISC. SERVICES	OPERATING SUPPLIES	0000062843	29.12	COFFEE MAKER
FIRE	OFFICE SUPPLIES	0000062768	57.10	RING BINDERS
		=====		
		TOTAL:	86.22	
RATHBONE SALES INC	00005021			
PARK RECREATION	REPAIR AND MAINTENANCE SUPPL	0000062822	40.61	OIL/SPARK PLUG/ELEMENT
		=====		
		TOTAL:	40.61	
REDDY ICE	00004329			
PARK RECREATION	CAMPGROUND RESALE	0000062742	198.00	ICE RESALE/CASCADE CAMPGROUND

DATE 7/20/12  
TIME 10:00:03

PAGE 13  
XAPPRVD

CITY OF MOSES LAKE  
TABULATION OF CLAIMS TO BE APPROVED  
COUNCIL MEETING OF  
07/24/2012

NAME OF VENDOR	VENDOR NO	Expenditure Account		
Department	Object Description	P.O. Number	P.O. Amount	Purpose of Purchase
=====				
		TOTAL:	198.00	
REDFLEX TRAFFIC SYSTEMS	00004837			
POLICE	PROFESSIONAL SERVICES	0000062838	15,507.87	PROF SERVICE/RED LIGHT TICKETS
=====				
		TOTAL:	15,507.87	
RI TEC INDUSTRIAL PRODUCTS	00005534			
WATER	OPERATING SUPPLIES	0000062811	750.00	MISC SUPPLIES
=====				
		TOTAL:	750.00	
SAFETY KLEEN CORP	00004265			
SEWER	REPAIR & MAINT. OTHER (CONTR	0000062812	234.28	SOLVENT CLEANING
=====				
		TOTAL:	234.28	
SAMARITAN HEALTHCARE	00001836			
AMBULANCE SERVICE	OPERATING SUPPLIES	0000062859	89.12	AMBULANCE SUPPLIES
=====				
		TOTAL:	89.12	
SATELLITE INDUSTRIES INC	00007631			
PARK RECREATION	SMALL EQUIPMENT < \$1000	0000062824	1,954.43	PORTABLE RESTROOMS
=====				
		TOTAL:	1,954.43	
SHERWIN-WILLIAMS	00006229			
PARK RECREATION	OPERATING SUPPLIES	0000062645	315.93	MISC SUPPLIES
PARK RECREATION	REPAIR AND MAINTENANCE SUPPL	0000062645	358.92	MISC SUPPLIES
=====				
		TOTAL:	674.85	
SHIRTBUILDERS INC	00004022			
PARK RECREATION	OPERATING SUPPLIES	0000062778	442.14	SnS STAFF SHIRTS
=====				
		TOTAL:	442.14	
STATE AUDITORS OFFICE	00003249			
FINANCE	PROFESSIONAL SERVICES	0000062850	4,598.00	PROF SERVICE/GEN AUDIT
=====				
		TOTAL:	4,598.00	
SUNTRUST	00007361			
EQUIPMENT LEASES	PRINCIPAL CAPITAL LEASE	0000062836	314.13	#35 LEASE PYMT/AUG
EQUIPMENT LEASES	INTEREST ON CAPITAL LEASES/I	0000062836	13.78	#35 LEASE PYMT/AUG
W/S LEASES	PRINCIPAL CAPITAL LEASE	0000062836	3,367.15	#35 LEASE PYMT/AUG
W/S LEASES	INTEREST ON CAPITAL LEASES/I	0000062836	186.34	#35 LEASE PYMT/AUG
EQUIP RENTAL-DEBT SR	PRINCIPAL CAPITAL LEASE	0000062836	9,326.47	#35 LEASE PYMT/AUG

DATE 7/20/12  
TIME 10:00:06

TOTALS PAGE  
XAPPRVD

CITY OF MOSES LAKE  
TABULATION OF CLAIMS TO BE APPROVED  
COUNCIL MEETING OF  
07/24/2012

TOTALS BY FUND

FUND NO	FUND NAME	AMOUNT
000	GENERAL FUND	105,931.87
102	TOURISM ACTIVITIES	87,087.33
116	STREET	45,413.54
275	EQUIPMENT LEASES	327.91
410	WATER/SEWER	42,824.57
477	WATER SEWER CONSTRUCTION	205,444.42
483	W/S LEASES	3,553.49
490	SANITATION FUND	21,673.05
493	STORM WATER	2,055.69
495	AIRPORT	438.18
498	AMBULANCE SERVICE FUND	6,768.36
517	CENTRAL SERVICES	2,308.10
519	EQUIPMENT RENTAL	48,234.97
528	BUILD MAINTENANCE	86,942.30
611	FIREMANS PENSION	1,449.00
	TOTAL	660,452.78

CHANGES TO BE MADE SHOULD BE LISTED BELOW

VEND NO.	P.O. NO.	AMT LISTED	CORRECTED AMT	ACTION TO BE TAKEN
.....	.....	.....	.....	.....
.....	.....	.....	.....	.....
.....	.....	.....	.....	.....

CORRECT AMOUNT TO BE PAID .....

\*\*\*\*\*  
\* CLAIMS APPROVAL \*  
\* WE, THE UNDERSIGNED COUNCILMEN OF THE CITY OF MOSES LAKE, WASHINGTON, DO HEREBY CERTIFY THAT THE MERCHANDISE \*  
\* OR SERVICES SPECIFIED HAVE BEEN RECEIVED AND THAT ABOVE CLAIMS ARE APPROVED, AS NOTED, FOR PAYMENT \*  
\* IN THE AMOUNT OF \$660,452.78 THIS 24TH DAY OF JULY, 2012 \*  
\* \*  
\* \*  
\* ..... \*  
\* COUNCIL MEMBER COUNCIL MEMBER \*  
\* \*  
\* \*  
\* ..... \*  
\* COUNCIL MEMBER FINANCE DIRECTOR \*  
\*\*\*\*\*

July 19, 2012

TO: City Manager  
For City Council Consideration

FROM: Municipal Services Director

SUBJECT: **Accept Work**  
**Civic Center Parking Lot and Landscaping Project - 2011**

Oceanside Construction has completed work for the 2011 Civic Center Parking Lot and Landscaping Project. This project included the construction of two parking lots, street improvements, irrigation systems, and landscaping and fencing for the Civic Center.

The contract was awarded to Oceanside Construction in the amount of \$864,300. The final contract amount for the work is \$867,376.

The contract work is physically complete and ready for acceptance by City Council. Upon acceptance of the contract, we will enter into the 60-day lien period as required by Washington State Law.

Respectfully Submitted,

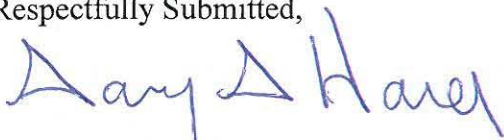
A handwritten signature in blue ink that reads "Gary Harer". The signature is stylized with a large, looped "G" and a trailing flourish.

Gary Harer, PE/PLS  
Municipal Services Director

July 19, 2012

TO: City Manager  
For City Council Consideration

FROM: Municipal Services Director

SUBJECT: **Consideration of Bids  
Long Line Striper (Rebid)**

Staff opened bids on July 3 for a long line striper. This will replace the 1979 long line striper the Street Division has operated.

The 2012 budget includes \$275,000 for this purchase. This cost includes emergency lighting and safety equipment to provide safe operations on high traffic streets.

The following three bids were received:

<u>Vendor</u>	<u>Brand</u>	<u>Total Bid With Tax</u>
M.B. Companies, Inc.	2013 Peterbilt	\$255,221
Mark Rite Lines Equipment Company	2013 Peterbilt	\$263,951
Vogel Traffic Services	2013 Peterbilt	\$313,726
Staff's Estimate		\$265,000

M.B. Companies, Inc. did not take any exceptions to the specifications.

Staff recommends City Council to award the bid to M.B. Companies, Inc. for the amount of \$255,221 including tax.

Respectfully Submitted,



Gary Harer, PE/PLS  
Municipal Services Director

July 19, 2012

TO: City Manager  
For Council Consideration

FROM: Municipal Services Director

SUBJECT: **Consideration of Bids**  
**Stratford Road Crosswalk Project – 2012**

Staff opened bids for the 2012 Stratford Road Crosswalk Project on July 10. The project includes a mid-block crossing with pedestrian warning beacons, reduced crosswalk width at Knolls Vista, and associated sidewalk, striping, stormwater and miscellaneous work. This project is funded by a \$150,000 Washington State Pedestrian and bicycle Safety Program Grant.

One bid was received from Neppel Electrical & Controls, LLC for the amount of \$135,511. The Engineer's estimate was \$115,454. Staff contacted several contractors to determine why they did not submit a bid. Their responses included the following: they had previous contract obligations, the project was too small, and the project is in a difficult location.

Staff recommends awarding the bid to Neppel Electrical & Controls, LLC in the amount of \$135,511.

Respectfully Submitted,

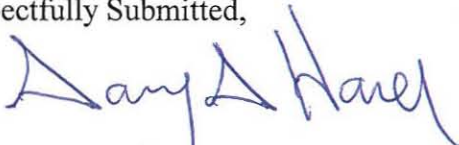
A handwritten signature in blue ink, appearing to read "Gary Harer", is written over the typed name.

Gary Harer, PE/PLS  
Municipal Services Director

ADDRESS AND  
ZC G MAP  
2011

STREET STREET NAME  
 LOTS  
 NEW PARCELS

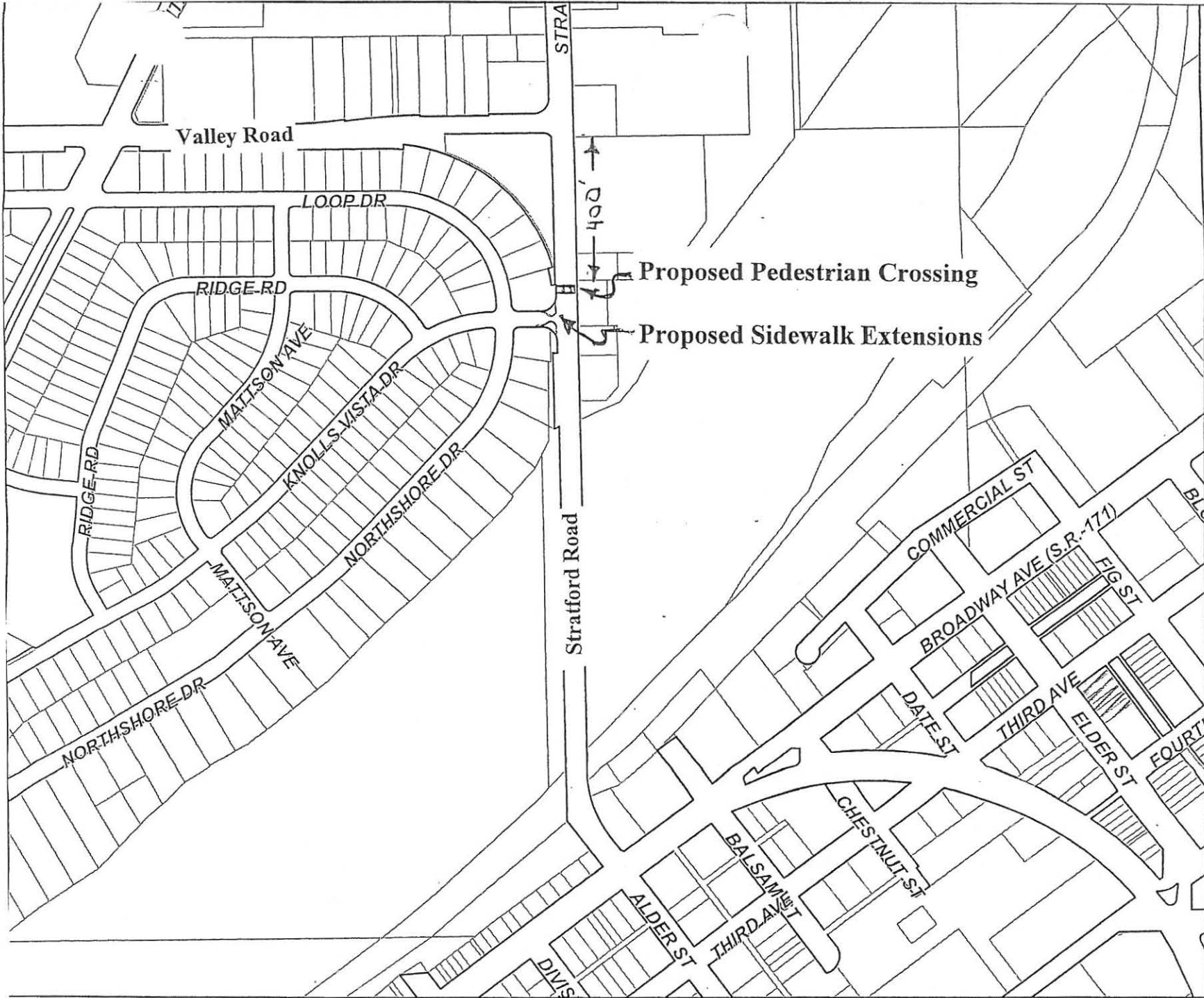

Proposed Pedestrian Crossing

Proposed Sidewalk Extensions

COUNTY  
INFO UPDATED  
MAY 20, 2011

0 225 450  
Feet



DRAWN: BKP  
Last Ordinance: 2607

PARCEL:  
OWNER:  
ADDRESS:  
NOTES:

Preliminary Drawing

**Sophia Guerrero**

---

**From:** George Doles [hard\_worker65@yahoo.com]  
**Sent:** Sunday, July 15, 2012 3:46 PM  
**To:** sguerrero@cityofml.com  
**Subject:** Request to be placed on agenda

Ms. Guerrero,

Could you please place the American Legion Riders of Post 209 on the Agenda for July 24, 2012 so that Monte Martin of the American Legion Riders can give the City Council an up-date as they requested.

Thank you.

George Doles, Commander  
American Legion Post 209  
Moses Lake, WA

July 19, 2012

TO: City Manager for Council Consideration  
FROM: Community Development Director  
SUBJECT: 631 Atlantic - Deferral/Deviation Requests - Firouzi

Reza Firouzi has submitted deferral and deviation requests of subdivision requirements for the proposed construction of a building at 631 Atlantic. The property is platted as Lot 12, Block 2 Vance Emery Plat but the improvements do not meet current codes.

Atlantic Street is gravel and there are no curb, gutter, or sidewalks. The request is to defer the street improvements on Atlantic Street at this time. If the request to defer the improvements is granted, a covenant for the improvements in the future would be required.

Respectfully submitted,

A handwritten signature in black ink, appearing to be 'GA', with a long horizontal stroke extending to the right.

Gilbert Alvarado  
Community Development Director

GA:jt

July 11, 2012

City Council of Moses Lake  
Building Dept  
Moses Lake, WA 98837

RE: Improvement Deferment for 631 Atlantic; Moses Lake, WA

Dear Sir(s);

The purpose of this letter is to respectfully request a deferment for making road, sidewalk, and other improvements required for city limits land developments.

I understand that the City will require property improvements in the future and the covenant requiring future improvements will run with the land.

Please allow this deferment and have the required covenant prepared for my signature.

Best Regards,

Reza Firouzi  
Firouzi Construction  
PO Box 1594  
Moses Lake, WA 98837



**RECEIVED**

JUL 11 2012  
COMMUNITY DEVELOPMENT  
PLANNING & BUILDING  
CITY OF MOSES LAKE

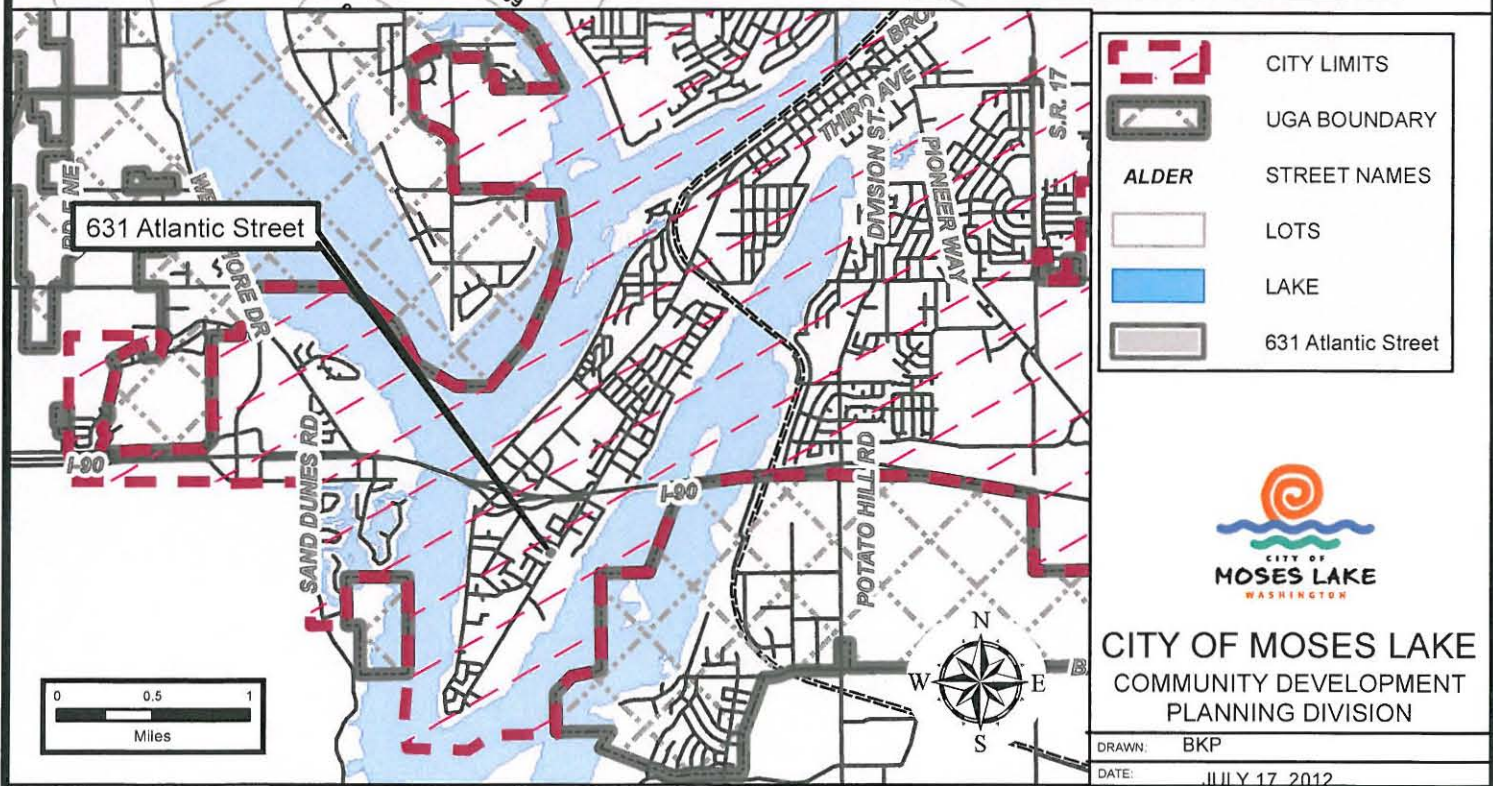

RECEIVED

JUL 13 2012

COMMUNITY DEVELOPMENT  
PLANNING & BUILDING  
CITY OF MOSELANE

June 13, 2012

TO: Community Development Director  
FROM: Municipal Services Director   
SUBJECT: **Request for Deferral to Construct Street Fronting 631 Atlantic Street**

I do not have any concerns with the approval of Mr. Firouzi's request.

Please let me know if you have any questions.

July 19, 2012

TO: City Manager for Council Consideration

FROM: Community Development Director

SUBJECT: Ordinance - Amend Chapter 18.20 - Residential Zone - Single Reading

It has come to the attention of the Community Development Department that the prior amendments to the footnotes for Table 2 in Section 18.20.050 were in error. The initial intent of the amendments were to allow appurtenances within the rear yard setback only. However, as the ordinance currently reads, appurtenances may be allowed to encroach within the front and rear yard setbacks.

The Community Development Department has received a request to encroach within the front yard set back. The Council should declare an emergency and adopt the attached ordinance on a single reading.

The attached ordinance is presented for Council consideration.

Attached is an ordinance amending Chapter 18.58, Signs, to include feather signs under the temporary sign provisions. The ordinance is presented for Council consideration. This is the second reading of the ordinance.

Respectfully submitted,



Gilbert Alvarado  
Community Development Director

GA:jt

ORDINANCE NO. 2651

AN ORDINANCE AMENDING CHAPTER 18.20 OF THE MOSES LAKE MUNICIPAL CODE ENTITLED "RESIDENTIAL ZONES"

THE CITY COUNCIL OF THE CITY OF MOSES LAKE, WASHINGTON ORDAINS AS FOLLOWS:

Section 1. Chapter 18.20 of the Moses Lake Municipal Code entitled "Residential Zones" is amended as follows:

18.20.050 Development Standards for Residential Zones:

- A. Purpose: This section establishes the site requirements and development standards for uses in the residential zones. The standards and rules are established to provide flexibility in project design, prevent fire danger, provide adequate access and circulation, reduce incompatibilities, and prevent overloading of infrastructure due to the impacts of development.
- B. Explanation of table: Development standards are listed down the left column of the table and the residential zones are identified across the top row. The matrix cells contain the requirements of each zone. The footnotes identify particular requirements applicable to a specific use, standard, or zone.

TABLE 2: DEVELOPMENT STANDARDS IN RESIDENTIAL ZONES				
Development Standards	R-1	R-2	R-3	R-4
Minimum lot size (in square feet) <sup>1</sup>	7000	7000	6000	32,670
Minimum lot size for a corner lot (in square feet)	7700	7700	6600	32,670
Minimum lot size for a two-family dwelling (in square feet) <sup>1</sup>	----	8000	6000	----
Additional lot area per dwelling unit in excess of 2 dwelling units (in square feet)	----	----	1200	----
Minimum lot depth	100'	100'	NS	150'
Minimum lot depth on an arterial	120'	120'	120'	150'
Minimum lot width <sup>2</sup>	65'	65'	NS	100'
Minimum lot width, corner lot	70'	70'	NS	150'
Minimum lot width for a two-family dwelling	----	70'	NS	----
Minimum street frontage for flag lots	20'	20'	20'	40'
Front yard setback <sup>3</sup>	25'	25'	15'	25'
Interior side yard setback <sup>3</sup> (each side)	----	----	5'	20'
If lot is 65' wide or less	5'	5'	----	----
If lot is more than 65'	7'	7'	----	----
Exterior side yard setback <sup>3</sup> for lots 65' or greater in width	25'	25'	15'	25'

TABLE 2: DEVELOPMENT STANDARDS IN RESIDENTIAL ZONES				
Development Standards	R-1	R-2	R-3	R-4
Exterior side yard setback <sup>3</sup> for lots less than 65' in width <sup>4</sup>	20'	20'	15'	----
Rear yard setback <sup>3</sup>	25'	25'	5'	25'
Rear yard setback <sup>3</sup> , corner lot less than 70' in width	10% of lot depth	10% of lot depth	5'	----
Rear yard setback <sup>3</sup> , corner lot 70' or greater in width	15% of lot depth	15% of lot depth	5'	25'
Setback from the ordinary high water mark of Moses Lake <sup>5</sup>	20' or 20% of lot depth, which ever is less	20' or 20% of lot depth, which ever is less	20' or 20% of lot depth, which ever is less	20' or 20% of lot depth, which ever is less
Maximum lot coverage for multi-family structures	----	----	50%	----
Minimum open space for multi-family	----	----	1000 SF + 100 SF per unit <sup>6</sup>	
Maximum height of primary structure <sup>7</sup>	30' <sup>8</sup>	30' <sup>8</sup>	40' <sup>9</sup>	30' <sup>11</sup>
Maximum height of detached accessory structure	16' <sup>10</sup>	16' <sup>10</sup>	16' <sup>10</sup>	35' <sup>11</sup>
Minimum width of narrowest portion of main residential structure	20'	20'	20'	20'
Minimum roof pitch of main roof of residential structure (vertical:horizontal)	3:12	3:12	3:12	3:12
Maximum height of floor level above grade (single level residential structures)	18"	18"	18"	18"
Minimum required number of covered <sup>12</sup> parking spaces	1	1	0	1

NS= No Standard

#### Footnotes for Table 2

##### 1. Exceptions:

- A. In the R-1 and R-2 zone, lots platted prior to 1961 shall have a minimum lot size of six thousand (6000) square feet.

- B. In the R-1, R-2, and R-3 zone, a building permit may be issued to a platted non-conforming lot that contains at least five thousand (5000) square feet and otherwise meets the underlying performance standards of the zone in at least eighty percent (80%) of the minimum bulk dimensions of width, depth, and building setback line.
- 2. In the R-1 and R-2 zone, lots platted prior to 1961 shall have a minimum lot width of sixty feet (60').
- 3. Setbacks
  - A. Within the setback area shown in Table 2, no building or structure (as defined in 18.06) shall be allowed, except flagpoles, signage, fencing, slope stability structures, and open steps and platforms having no roof covering. Eaves, cornices, and awnings may project into the required setback no more than two feet (2').
  - B. The setbacks shown in the table are zoning setbacks. Larger setbacks may be required by the State Building Code, State Fire Code, sight distance requirements, or landscaping requirements (MLMC 18.57).
  - C. There shall be no side yard setback requirement for single family dwelling units sharing a common wall or attachment when each dwelling is on its own lot of record.
  - D. To determine the interior side setback requirement in the R-1 and R-2 zones, the lot width shall be measured at the front setback line for rectangular lots. For all other lot shapes, the average of the width at the front setback line and rear setback line shall be used to calculate the required interior side setback.
  - E. Within the setback area shown in Table 2, attached appurtenances such as, but not limited to, awnings, porch covers, and pergolas may encroach into the required rear yard setback no more than fifteen feet (15'). Any such attached appurtenance shall remain open and shall not be enclosed with walls for the purpose of creating habitable living space.
- 4. Except that residential structures in the R-1 and R-2 zone may conform to existing structures within two hundred feet (200') along either street but in no case shall a building be permitted less than fifteen feet (15') from a property line abutting a street.
- 5. Setback from the ordinary high water mark of Moses Lake:
  - A. This setback does not apply to water-dependent structures such as docks or boathouse. Structures located within a lakefront rear yard shall be in compliance with Chapter 18.45 entitled C-R Zone and the Shoreline Master Program.
  - B. Lawfully existing structures built prior to the adoption of this ordinance shall not be required to comply with this setback. Building permits for lots in subdivisions approved prior to the adoption of this ordinance shall not be required to meet this setback. Subdivisions approved after the adoption of this ordinance and the request for building permits on lots in these subdivisions shall meet this setback.
- 6. Open space shall not include parking areas or driveways and shall be usable outdoor area for recreation and landscaping. The smallest dimension of the open space area shall be not less than fifteen feet (15').
- 7. The following structures are exempt from the building height restriction and may be erected higher than thirty feet (30') so long as the structure permitted is a distance from all property lines not less than its height and it meets any additional conditions as noted:

- A. Church spires, steeples, and bell towers. Other portions of a church building may exceed thirty feet (30') if addressed as part of the conditional use permit for the building.
  - B. Flag poles.
  - C. Non-commercial antennas and towers related to wireless transmissions and relays, if permitted by law, so long as those towers are no higher than necessary to reasonably accommodate the use including the use of the shortest structure possible and crank-up or telescoping devices are used whenever possible.
  - D. Water reservoirs.
8. In the R-1 and R-2 zones, a primary structure may be constructed up to thirty-five feet (35') in height under the following conditions:
- A. The interior side yard setback must be at least ten feet (10') with one additional foot of setback for each additional foot of building height over thirty feet (30') to a maximum required setback of fifteen feet (15').
  - B. A minimum lot size of twelve thousand five hundred (12,500) square feet.
9. In the R-3 Zone a primary structure may be constructed up to forty feet (40') in height under the following conditions:
- A. The rear yard and interior side yard setback must be at least ten feet (10') with one additional foot of setback for each additional foot of building height over thirty feet (30') to a maximum required setback of fifteen feet (15').
  - B. A minimum lot size of twelve thousand five hundred (12,500) square feet.
10. A detached accessory building in a residential zone may exceed sixteen feet (16') in height under the following conditions:
- A. Minimum lot size of fifteen thousand (15,000) square feet.
  - B. Minimum lot width of eighty feet (80').
  - C. Accessory building, primary structure, and impervious surfaces combined do not cover more than fifty percent (50%) of lot.
  - D. Any building over sixteen feet (16') in height must be consistent with the exterior of the primary structure in architectural style, siding, paint, roof pitch, and roofing material. If the primary structure has multiple roof pitches, the accessory building need only match one of them.
  - E. Interior side yard and rear yard setbacks as required by current code plus one additional foot for each additional foot in height over sixteen feet (16').
  - F. Building to be no taller than 26' or the height of the house, whichever is less.
  - G. Blank wall facades created by an accessory building over sixteen feet (16') in overall height and twenty-four feet (24') in width or length will require one window, with one (1) additional window required for each additional twelve feet (12') in width or length. Window trim shall match the window trim on the front of the house.

11. In the R-4 Zone, a primary or accessory structure may be constructed up to thirty-five feet (35') when the interior side yard setback is increased by one foot (1') of setback for each additional foot of building height over thirty feet (30').

12. In a garage or carport constructed to the standards of the State Building Code.

Section 2. The City Council declares that an emergency exists and this ordinance is deemed a public emergency ordinance necessary for the protection of public health, public safety, public property, or public peace and shall take effect immediately as provided by law upon one reading if a majority plus one of the whole membership of the City Council vote in favor of passage.

Adopted by the City Council and signed by its Mayor on July 24, 2012.

\_\_\_\_\_  
Bill J. Ecret, Mayor

ATTEST:

\_\_\_\_\_  
W. Robert Taylor, Acting Finance Director

APPROVED AS TO FORM:

\_\_\_\_\_  
Katherine L. Kenison, City Attorney

July 19, 2012

TO: City Manager for Council Consideration  
FROM: Community Development Director  
SUBJECT: Ordinance - Amend Chapter 18.58 - Signs - 2<sup>nd</sup> reading

The City Council at their April 24 meeting directed the Planning Commission to study the issue of tear drop or feather signs under the framework of Chapter 18.58, Signs. The existing sign code is silent on these types of signs and, therefore, it is difficult to regulate them.

The Commission studied the existing sign code along with examples of how other jurisdictions regulate these types of signs and recommended that language be incorporated in the sign code that would include the feather signs in an existing sign category. The category that best fit the feather signs was under the temporary sign provisions.

It should be noted that with the 1<sup>st</sup> reading of the subject ordinance, Council asked staff to come back with added language that provides measures to secure the signs to the surface they are attached to. Staff could not find any reasonable means to do this and have not included any measures so the security of the sign is left to the owners. Code Enforcement will monitor for safety.

Attached is an ordinance amending Chapter 18.58, Signs, to include feather signs under the temporary sign provisions. The ordinance is presented for Council consideration. This is the second reading of the ordinance.

Respectfully submitted,

A handwritten signature in blue ink, appearing to be 'Gilbert Alvarado', written over the typed name.

Gilbert Alvarado  
Community Development Director

GA:jt

ORDINANCE NO. 2652

AN ORDINANCE AMENDING CHAPTER 18.58 OF THE MOSES LAKE MUNICIPAL CODE ENTITLED "SIGNS"

THE CITY COUNCIL OF THE CITY OF MOSES LAKE, WASHINGTON ORDAINS AS FOLLOWS:

Section 1. Chapter 18.58 of the Moses Lake Municipal Code entitled "Signs" is amended as follows:

18.58.020 Definitions:

- A. Abandoned Sign: means a sign which no longer serves its intended purpose.
- B. Architectural Appendage Sign: means a building sign that is suspended from, attached to, applied to, or part of an awning, marquee, false mansard, canopy, or similar projection from the exterior walls of a building.
- C. Billboard: means an off-site sign that is substantial in size and construction, usually is owned by an outdoor advertising company, and contains advertising space that is for rent or lease.
- D. Building: means an enclosed structure for a use or occupancy.
- E. Building Sign: means any sign that is attached or applied to, mounted on, suspended from, painted on, or part of the exterior of a building or architectural appendage, including the roof and facade.
- F. Cabinet Sign: means a sign enclosure which has access for the replacement of one (1) or more sign faces and lamps, if internally-illuminated.
- G. Changeable Copy Sign: means a sign that is designed to easily rotate or alternate messages by mechanical means. Examples of changeable copy signs are reader boards with removable letters.
- H. Community Sign: means a temporary sign that promotes, celebrates, or commemorates a community event, public awareness, community service, holiday season, or similar public function.
- I. Construction Sign: means a temporary standing or portable sign that is non-illuminated. A construction sign provides information about a construction project.
- J. Directional Sign: means a sign which only identifies a business or activity and directs traffic to that business or activity.
- K. Directory Sign: means a sign that has space which is limited to the name, address, and logo of the developed site and the names, addresses, and logos of several on-site businesses, organizations, or facilities.
- L. Double-Face Sign: means two (2) sign faces which are identical in size and message and either are displayed back-to-back or within 30° interior angle.
- M. Electronic Sign: means an on-premise advertising sign having a signboard display that can be changed by an electrical, electronic, or computerized process.
- N. Facade: means one (1) or more exterior walls of a building that face one (1) direction, including parapets and openings such as doors and windows.

- O. Flashing Sign: means a sign that has external or internal lighting which changes intensity, rotates, animates, travels, or switches on and off in a blinking manner. Examples of such lighting are lamp banks with blinking or traveling messages, traveling arrows and revolving beacons.
- P. Free-Standing Sign: means a sign that has vertical support which is permanently anchored in the ground. Examples are pole (or pylon), post, and monument signs.
- Q. Freeway Interchange Sign: means a free-standing sign that is intended to attract the attention of traffic entering or exiting an Interstate 90 interchange. A freeway interchange sign is located within one thousand five hundred feet (1,500') of the interchange as measured from the centerline of Interstate 90 right-of-way and the intersecting right-of-way centerline.
- R. Freeway Sign: means a free-standing sign that is intended to attract the attention of traffic on Interstate 90. A freeway sign is located within two hundred fifty feet (250') of Interstate 90 right-of-way.
- S. Garage Sale Sign: means a temporary sign for the sale of household items.
- T. Home Occupation Sign: means an on-site sign that advertises a home occupation as defined in Section 18.55.020 of this title.
- U. Incidental Sign: means a non-illuminated, on-site, convenience sign. Examples of incidental signs are credit card, telephone, and restroom signs.
- V. Monument Sign: means a free-standing sign in the shape of a monolith. Usually the sign is vertically supported on a base which is on a pedestal, but the sign may be a pole-covered sign. A monument sign is intended to be viewed at eye level.
- W. Non-Conforming Sign: means a permanent sign that was lawfully erected, installed, or otherwise displayed according to the applicable Grant County or city zoning regulations, but does not conform to the sign regulations of this chapter.
- X. Off-Site Sign: means a sign that is not related to an activity that is on the same site as the sign, or the sign is on a vacant site.
- Y. Official Sign or Legal Notice: means an official sign or legal notice issued by a court, public agency, or as authorized by law or federal, county, or city authority.
- Z. On-Site Sign: means a sign that is related to an activity that is on the same site as the sign.
- AA. Permanent Sign: means any sign which is not a temporary sign as defined in Section 18.58.020.OO.
- BB. Pole (or Pylon) Sign: means a free-standing sign on one (1) or more upright supports in a foundation. The upright supports may be covered for aesthetic purposes. A pole sign is the same as a pylon sign.
- CC. Portable Sign: means a sign that either is a sign structure or is part of or affixed to a sign structure that is designed to be movable.
- DD. Private Warning/Directional Sign: means a permanent, portable, or temporary sign that is erected for a private purpose such as KEEP OUT, NO TRESPASSING, RIGHT TURN ONLY, STOP, SECURITY ALARM, or NO DUMPING.

- EE. Projecting Sign: means a type of building sign that either is: 1) mounted at right angle to a facade; 2) suspended under an architectural appendage and at right angle to a facade; or 3) a wall sign that extends eighteen (18) or more horizontal inches from the facade.
- FF. Public Facility Directional Sign: means a sign, in the public zone, which only identifies a public facility or activity and directs traffic to that public facility or activity.
- GG. Public or Recreational Identification Sign: means a sign for a public or semi-public facility or area. Examples of such signs are park, school, or hospital signs.
- HH. Real Estate Sign - Other: means a sign that either advertises a parcel or lot of non-residential land, or the buildings thereon, or both which is for sale, lease, or rent.
- II. Real Estate Sign - Residential Lot: means a sign that either advertises a parcel or lot of residential land, or the buildings thereon, or both which is for sale, lease, or rent. Residential land includes land that is vacant and within a residential zone or land that is in residential use, regardless of zone.
- JJ. Residential Identification Sign: means a sign that identifies a residential subdivision, planned residential development, neighborhood, condominium development, manufactured home park, multi-family residential development, or similar residential developments.
- KK. Residential Subdivision Sign: means a sign which advertises the sale of lots in a residential subdivision, parcels in a manufactured home binding site plan, or lots in a residential planned development.
- LL. Right-Of-Way: means a corridor which either is reserved for or contains a public street, road, alley, pathway, highway, or freeway.
- MM. Roof Sign: means a building sign that is mounted on the roof of a building as defined in this section. A roof sign does not project beyond the vertical planes of the building facades.
- NN. Sandwich Board Sign: means a portable sign that is A-frame, does not exceed four feet (4') in height or two feet (2') in width, and is non-illuminated.
- OO. Sign: means a visual message that is displayed to attract the outdoor attention of the general public. A sign may be: 1) advertising of a generic or specific product, item, or service; 2) a promotion of an activity or event; 3) any other implicit or explicit message which informs, alerts, directs attention to, or warns; 4) the name of a business, building, place, or organization; or 5) any combination of advertising, promotion, other message, or name. A sign may consist of, but is not limited to words, pictures, drawings, logos, symbols, other graphics, border, trim, frame, cabinet, background, space, material, or devices which are integral to the visual message. A sign may contain multiple visual messages which are related in content and proximity.
- PP. Sign Face: means one dimension of a sign that contains the visual message.
- QQ. Sign Height: means the vertical distance as measured from finished grade at the base of a sign or sign structure to the top of the sign.
- RR. Sign Structure: means the horizontal and vertical support for a sign.
- SS. Site: means either: 1) a parcel of unplatted land, a parcel in a binding site plan, a tract, or a lot in a subdivision; or 2) two (2) or more contiguous parcels, tracts, or lots under one (1) ownership without intervening right-of-way and identified or delineated as one (1) development site; or 3) two (2) or more contiguous parcels, tracts, or lots under different

ownerships, without intervening right-of-way, and identified or delineated as one (1) development site.

- TT. Street Frontage: means that portion of a site boundary that borders one or more streets as defined in Section 18.06.590.
- UU. Temporary Sign: means a sign affixed to, applied on, or made from lightweight material, with or without a frame or backing which is designed to be displayed for a limited time including, but not limited to, a feather or tear drop sign. Examples of lightweight materials are vinyl, cardboard, card stock, corrugated plastic, and fabric.
- VV. Traffic Control Sign: means any permanent or temporary traffic control, traffic signal, or construction sign that is subject to: 1) the latest edition of the Standard Specifications for Road, Bridge, and Municipal Construction as published by the Washington State Department of Transportation in conjunction with the Washington State Chapter of the American Public Works Association, as amended by the City of Moses Lake Community Street and Utility Standards; and 2) the Manual on Uniform Traffic Control Devices.
- WW. Vehicle Sign: means a sign that is affixed or painted on a vehicle which is primarily used for transportation rather than parked for the purpose of displaying the sign.
- XX. Wall Sign: means a building sign that is painted or flush-mounted on a facade, fascia, or architectural appendage, less than eighteen inches (18") horizontal projection.
- YY. Wheeler Corridor Heavy Industrial Area: means the area within City limits, located east of Road L and zoned Heavy Industrial.
- ZZ. Window or Door Sign: means a building sign that is suspended or mounted flush with an exterior window, or painted on a window or door, and directed outside.

#### 18.58.030 Sign Regulations:

- A. Only a sign as defined in Section 18.58.020. ~~OO~~ ~~MM~~ is subject to the provisions of this chapter.
- B. A sign type that is listed "A" in the following table is allowed to be displayed, subject to the applicable sign regulations listed in this section and in the table.
- C. A sign type that is listed "P" in the following table is prohibited from display, unless it is a non-conforming sign as provided in Section 18.58.090.
- D. A sign type that is listed "E" in the following table is exempt from the provisions of this chapter.
- E. A sign type that is not listed in the following table is not allowed to be displayed.
- F. A sign shall comply with applicable provisions of the State Building Code and Chapter 16.02 of this code entitled Building Permits.
- G. A sign is subject to Chapter 8.14 of this code entitled Nuisances.
- H. State law (RCW 70.54.090) prohibits the attachment of a sign to a utility pole.
- I. No sign is allowed on or over right-of-way except as approved by City Council for city streets. No sign is allowed within right-of-way of the interstate or primary system where

there are no curbs. A sign may be allowed within right-of-way of the primary system where there are curbs and other streets, subject to the following conditions and circumstances:

1. A projecting sign is allowed over a sidewalk in right-of-way in the C-1 Zone and in the C-2 Zone where the building is not set back from right-of-way, provided that the sign does not project more than eighty percent (80%) of the distance between the right-of-way line and back of curb line, and there is a minimum of eight feet (8') vertical clearance under the sign
  2. A political sign is allowed in right-of-way subject to the remainder of the applicable sign regulations in this section and in the following table.
- J. No permanent sign is allowed on or over a public utility easement.
- K. A permanent sign may be allowed over but not on a municipal easement, upon approval by the Municipal Services Director.
- L. Every sign shall be maintained in a safe and secure manner. A torn, broken, hazardous, dilapidated, or outdated sign, as determined by the Building Official, shall be repaired, replaced, or removed.
- M. The City Engineer shall review each application for a sign permit for sight distance. The City Engineer shall consider whether a sign would be located or constructed so as to obscure or obstruct an official traffic sign, signal, or device, or obstruct a motorist's view of approaching, merging, or intersecting traffic before approving or disapproving the application.
- N. Internal or external sign lighting shall be shaded, hooded, site screened, or directed so that the light's intensity or brightness shall neither adversely affect adjacent or nearby property, nor create a public nuisance, nor create a traffic hazard.
- O. A sign may be located within the front or exterior yard (as defined in sections 18.06.630 and 18.06.650 of this title) but shall not be located in the interior side or rear yard (as defined in sections 18.06.650 and 18.06.640 of this title).
- P. Where electronic signs are allowed, the following conditions apply:
1. The message shall have a static display time of at least two (2) seconds after moving on to the signboard, with all segments of the total message to be displayed within ten (10) seconds.
  2. Displays may travel horizontally or scroll vertically onto electronic signboards, but must hold in a static position for two (2) seconds after completing the travel or scroll.
  4. Electronic signs requiring more than four (4) seconds to change from one (1) single message display to another shall be turned off during the change interval.
  5. No electronic sign lamp may be illuminated to a degree of brightness that is greater than necessary for adequate visibility. In no case may the brightness exceed eight thousand (8,000) nits or equivalent candelas during daylight hours, or one thousand (1,000) nits (illuminative brightness measurement), or equivalent candelas between dusk and dawn. Signs found to be too bright shall be adjusted as directed by the City of Moses Lake.
  6. Minimum height for the sign shall be thirteen feet (13') from grade of the adjacent roadway to the bottom of sign.

7. The sign background shall not be white in color. White lights shall not be used as the sign background.
  8. Businesses, churches, or schools are allowed changeable signs providing that changeable displays in residential zones shall be turned off between the hours of 10 p.m. and 7 a.m.
- Q. No sign shall be erected or maintained if it is visible from the main traveled way of the interstate or primary system except as permitted by Washington Administrative Code Chapter 468-66 entitled HIGHWAY ADVERTISING CONTROL ACT or Revised Code of Washington Chapter 47.42 entitled HIGHWAY ADVERTISING CONTROL ACT - SCENIC VISTAS ACT.
- R. Signs constructed of temporary sign materials, as defined in Section 18.58.010.TT, shall not be used as a permanent sign. Any sign that does not currently meet this standard must be removed within ninety (90) days.

#### SIGN REGULATIONS

Sign Type	Prohibited, Allowed, or Exempt	Maximum Sign Height	Maximum Sign Area	Sign Permit	Other Sign Regulations
Abandoned	P	NA	NA	NA	NA
Architectural Appendage	A	Sign may be flush-mounted or suspended under the architectural appendage	see Building sign	R	Sign allowed only in commercial and industrial zones. If the sign is suspended, there shall be at least 8' clearance above grade.
Billboard	P	NA	NA	NA	NA
Building	See specific types of building signs	See specific types of building signs	The total area of building signs shall not exceed 25% of the overall area of each facade. None of this allowance is transferable from one facade to another facade. No individual building sign shall exceed 15% of the overall area of a facade.	See specific types of building signs	Sign allowed in commercial, industrial, agricultural, and municipal airport zones. Allowed in R-3 Zone on a site with a conditional use, with review and approval of the Planning Commission according to Section 18.58.110 of this chapter.
Changeable Copy	A	25' for Free-standing, Freeway or Freeway Interchange sign, or wall height for Wall sign	See Building, Freeway or Freeway Interchange, Free-standing, or Temporary Free-standing or Portable sign	R	Sign allowed only in commercial and industrial zones.
Community	A	See Building or Free-standing signs.	See Building, Free-standing, and Temporary Free-standing or Portable signs for other sign area regulations.	R if free-standing sign; NR if building sign	Sign allowed only in commercial, industrial, and public zones. Sign shall be temporary.

Sign Type	Prohibited, Allowed, or Exempt	Maximum Sign Height	Maximum Sign Area	Sign Permit	Other Sign Regulations
Construction	A	8'	32 sq. ft. per street frontage per construction site	NR	Sign may be erected a maximum of 30 days prior to start of construction, and shall be removed within 30 days after the end of construction. Sign shall be non-illuminated. Limited to one sign per street frontage per site.
Dilapidated or hazardous condition as determined by Building Official	P	NA	NA	NA	NA
Directional	A	6' for Free-standing sign; same as for Wall sign.	8 sq. ft. per sign	R	Sign allowed only in commercial and industrial zones
Directory	A	Same as for Free-standing, and Freeway or Freeway Interchange sign	See Building, Freeway or Freeway Interchange, or Free-standing sign	R	Sign allowed only in commercial and industrial zones, or on a site with a conditional use in the R-3 Zone. Prior to issuance of a sign permit, a sign for a conditional use in the R-3 Zone shall require Planning Commission review and approval according to Section 18.58.110 of this chapter.
Electronic	A	25'	50 sq. ft. per site. Area of electronic signs is included within the maximum area allowed for free-standing or building signage	R	Sign allowed only in Commercial, Industrial, and Public Zones. Additional requirements for electronic signs are found in Section 18.58.030, Sign Regulations. Electronic signs must also meet the requirements for the type of sign (free-standing or building).
Flashing	P	NA	NA	NA	NA
Freeway or Freeway Interchange or Wheeler Corridor Heavy Industrial	A	45'	350 sq. ft. per site	R	Allowed only in commercial and industrial zones. Wheeler Corridor signs allowed only in the Wheeler Corridor Heavy Industrial Area. Off-site signs shall not be allowed.

Sign Type	Prohibited, Allowed, or Exempt	Maximum Sign Height	Maximum Sign Area	Sign Permit	Other Sign Regulations
Free-standing	A	25'	150 square feet per site in a commercial or industrial zone, except that a site which has street frontage exceeding 300 lineal feet is allowed 150 square feet per increment of 300 lineal feet of street frontage. A site where there is a conditional use in the R-3 Zone is allowed any combination of free-standing and building signs not to exceed a total of 12 square feet, except as provided in Other Sign Regulations in this row.	R	Sign allowed only in commercial and industrial zones or on a site where there is a conditional use in the R-3 Zone. A site without street frontage shall be limited to one free-standing sign structure. The number of free-standing sign structures that are allowed on a site with street frontage shall be limited to two per increment of 300 lineal feet of street frontage. If a site exceeds one free-standing sign structure, then the structures shall be separated a minimum of 100 lineal feet. Landscaping (as defined in section 18.57.030.A of this title) is required around the base of a new free-standing sign. The landscaping perimeter for a pole sign shall be not less than the largest sign dimensions as vertically projected to the ground. The landscaping perimeter for all other free-standing signs shall be not less than 1' larger than the base of the sign structure. Prior to issuance of a sign permit, a free-standing sign on a vacant site, or where there is a conditional use in the R-3 Zone, shall require Planning Commission review and approval according to Section 18.58.110 of this chapter.
Garage Sale	A	NA	NA	NR	Sign allowed in all zones. The sign shall not be displayed for more than four consecutive days.
Government Flags	E	NA	NA	NA	NA
Home Occupation	A	Same as for Wall sign	2 sq. ft. per residential dwelling unit with home occupation license	R	Sign shall be a non-illuminated wall sign. Limited to one sign per residential dwelling unit with home occupation license.
Incidental	A	Same as for Wall, Freeway, Freeway Interchange, and Freeway signs	2 sq. ft. per sign	NR	Shall be non-illuminated and on-site.
Monument	A	8'	Same as for Free-standing Sign	R	Sign allowed only in commercial and industrial zones
Non-conforming	See Section 18.58.090 for limitations on non-conforming signs				
Official Sign or Legal Notice	E	NA	NA	NA	NA

Sign Type	Prohibited, Allowed, or Exempt	Maximum Sign Height	Maximum Sign Area	Sign Permit	Other Sign Regulations
Open, Closed, Business Hours, Address, or Greeting	E	NA	NA	NA	NA
Political (candidate or issue)	A	8'	32 square feet per sign	NR	Shall be removed within 10 days after an election. May be located on private property with permission from property owner. May be placed in right-of-way adjacent to the private property of the abutting land owner and only with the permission of the private property owner/abutting land owner, provided that it is not in a location or condition that is prohibited.
Private Warning/ Directional	E	NA	NA	NA	NA
Projecting Sign	A	Same as for Wall or Architectural Appendage sign	See Building sign	R	See Section 18.58.030 I of this chapter
Public Facility Directional Sign	A	8'	35' sq. ft.	R	Sign allowed only in the public zone
Public or Recreational Identification	A	Same as for Free-standing or Building sign	See Free-standing or Building sign	R	Allowed in commercial, industrial, and public zones
Public Zone (other than Public or Recreational Facility Identification signs)	A	Same as for Free-standing or Building sign	see Free-standing or Building sign	R	Requires Planning Commission approval according to Section 18.58.110.
Real Estate - Other	A	8' for Free-standing Sign; wall height for Building Sign	32 sq. ft. per sign	NR	Shall be non-illuminated. Shall be removed from display within five days after sale, lease, or rent.
Real Estate - Residential Lot	A	8'	6 sq. ft. per sign	NR	Shall be non-illuminated. Shall be removed from display within one day after sale, lease, or rent.
Residential Identification	A	8'	32 sq. ft. per site	R	Allowed in residential zones. Requires Planning Commission review and approval according to Section 18.58.110 of this chapter.
Residential Subdivision	A	8'	32 sq. ft. per residential subdivision, manufactured home binding site plan or residential planned development	R	N/A

Sign Type	Prohibited, Allowed, or Exempt	Maximum Sign Height	Maximum Sign Area	Sign Permit	Other Sign Regulations
Roof	A	10' above roof height as measured from intersection of the roof and lowest point of the sign, sign structure, or point of attachment	See Building sign	R	Allowed in commercial and industrial zones.
Sandwich Board	A	4'	8 sq. ft. each face	R	Sign allowed only in commercial and industrial zones. May be located in right-of-way adjacent to the site that is the object of the sign with Community Development Department approval. Otherwise, sign shall be on-site. Shall be removed from display at the end of each business day.
Sign which could be confused with or obstructs the view of a traffic sign or signal, as determined by City Engineer	P	NA	NA	NA	NA
Sign which restricts ingress to or egress from a building	P	NA	NA	NA	NA
Sign on vehicle other than Vehicle sign	P	NA	NA	NA	NA
Temporary Sign on Fence	A	Height of fence	32 sq. ft. per street frontage	NR	Allowed only for community signs, as defined in this chapter
Temporary Sign on free-standing structure or Portable	A	See Free-standing if on free-standing structure; 8' height if portable	32 sq. ft. per street frontage per site. If no street frontage, then 32 sq. ft. per site. The total sign area shall be restricted to one, contiguous, designated area per street frontage. The designated area shall not exceed 12 lineal feet parallel to street frontage.	R - one time per location. Ownership change of business license requires new sign permit.	Allowed only in commercial and industrial zones. Sign shall be repaired, replaced, or removed when torn, worn, broken, or dilapidated. Sign shall be specific to a product or event, and shall not include the business name or hours. Off-site signs shall not be allowed, except that the Planning Commission may allow a temporary sign on a vacant site pursuant to 18.58.100.
Temporary Gas Pump	A	NA	2 sq. ft. per sign, one sign per dispenser	NR	NA

Sign Type	Prohibited, Allowed, or Exempt	Maximum Sign Height	Maximum Sign Area	Sign Permit	Other Sign Regulations
Temporary Sign On Wall	A	Same as Wall sign	See Building sign Signs shall be framed. One sign per building allowed if unframed.	NR	Allowed only in commercial and industrial zones. Sign shall be repaired, replaced, or removed when torn, worn, broken, or dilapidated. Sign shall be specific to a product or event, and shall not include the business name or hours. Off-site signs shall not be allowed. Signs shall not be located on out buildings.
Traffic Control	E	NA	NA	NA	NA
Vehicle	A	Flush-mounted to vehicle	NA	NR	Non-illuminated
Wall	A	The sign shall be contained within the outline of the facade.	See Building sign	R	NA
Window or Door	A	The sign shall be contained within the perimeter of the window or door	See Building sign	N R for temporary sign; R for permanent sign	NA
A = Allowed E = Exempt NA = Not Applicable NR = Not Required P = Prohibited R = Required					

Section 2. This ordinance shall take effect and be in force five (5) days after its passage and publication of its summary as provided by law.

Adopted by the City Council and signed by its Mayor on July 24, 2012.

\_\_\_\_\_  
Bill J. Ecret, Mayor

ATTEST:

\_\_\_\_\_  
W. Robert Taylor, Acting Finance Director

APPROVED AS TO FORM:

\_\_\_\_\_  
Katherine L. Kenison, City Attorney

July 17, 2012

To: City Manager for Council Consideration

From: Acting Finance Director

Subject: Resolution - Petty Cash change fund

Attached is a resolution which increases the General Fund Petty Cash Change Fund for Parks and Recreation to \$1500. The increase is needed because of the added demand during the weekends due to the expansion at the Surf n Slide.

The resolution is presented for Council consideration.

Respectfully submitted

A handwritten signature in blue ink, appearing to read "W. Robert Taylor".

W. Robert Taylor, CGFM  
Acting Finance Director

RESOLUTION NO. 3301

A RESOLUTION INCREASING THE PETTY CASH ACCOUNT IN THE PARKS AND  
RECREATION DEPARTMENT

Recitals:

1. The Parks and Recreation Director and the Finance Director are requesting that, due to the need for weekend change, the Paks and Recreation change fund be increased.
2. RCW 42.26.060 allows for the establishment and use of such petty cash accounts.

Resolved:

1. That the Parks and Recreation change fund be increased to \$1,500.

Adopted by the City Council on July 24, 2012.

\_\_\_\_\_  
Bill J. Ecret, Mayor

ATTEST:

\_\_\_\_\_  
W. Robert Taylor, Acting Finance Director

May 22, 2012

TO: Finance Director

FROM: Parks & Recreation Director 

SUBJECT: Change Fund for Surf n' Slide Water Park

I am requesting that we increase the change fund for Surf n' Slide Water Park by \$1,000. This requested increase is due to the high volume of weekend traffic that we experience every year at this facility. With the banks closing early on Saturdays and not open at all on Sundays we frequently run out of change and have to send employees all over town requesting change from a variety of businesses that are open. This would allow us to have sufficient funds available on-site for making change.

If you need further information, please contact me.

Thank you for your consideration.

July 10, 2012

TO: City Manager for Council Consideration

FROM: Parks and Recreation Director

SUBJECT: Donation of Funds for Park Bench in Memory of Myrna K. Corbett

Attached for Council approval is a resolution accepting donations in memory of Myrna K. Corbett in the amount of \$500.00. These monies are to be used for the purchase of a park bench from the Parks Department Gifts and Memorials Catalog to be placed at Civic Center Park in honor of Myrna K. Corbett.

Moses Lake Parks and Recreation Department would like to thank the friends and family of Myrna K. Corbett for their donation and support of recreation programs and facilities for Moses Lake citizens and visitors.

Respectfully submitted,

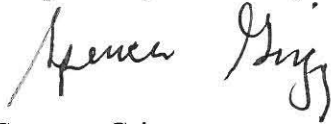
A handwritten signature in cursive script, appearing to read "Spencer Grigg".

Spencer Grigg  
Parks and Recreation Director

attachment:

SG:kf

RESOLUTION NO. 3302

A RESOLUTION ACCEPTING DONATIONS TOTALING \$500 IN  
MEMORY OF MYRNA K. CORBETT FOR THE PURCHASE OF A  
PARK BENCH FROM THE MOSES LAKE PARKS GIFTS AND  
MEMORIALS CATALOG

RECITALS:

1. Friends and family of Myrna K. Corbett have donated five hundred dollars (\$500.00) to the City of Moses Lake to be used for the purchase of a park bench from the Parks Department Gifts and Memorial Catalog.

RESOLVED:

1. The \$500.00 donation is accepted.
2. The City of Moses Lake wishes to express its sincere appreciation to the friends of family of Myrna K. Corbett.

Adopted by the City Council on \_\_\_\_\_.

\_\_\_\_\_  
Bill Ecret, Mayor

ATTEST:

\_\_\_\_\_  
Robert Taylor, Finance Director

July 16, 2012

TO: City Manager  
For City Council Consideration

FROM: Municipal Services Director

SUBJECT: **Construction Work Hours**  
**Five-Corners Improvement Project – 2012**

Neppel Electric and Controls request permission to work between the hours of 10 p.m. and 7 a.m. to complete the wiring for the signal heads at the five-corners intersection. This will help complete this work when there is less traffic congestion. The duration would be September 7, 8 and 9, 2012.

Moses Lake Municipal Code 8.28.050.B.3 requires City Council approval for construction work between the hours of 10 p.m. and 7 a.m.

This request is presented to the City Council for consideration.

Respectfully Submitted,

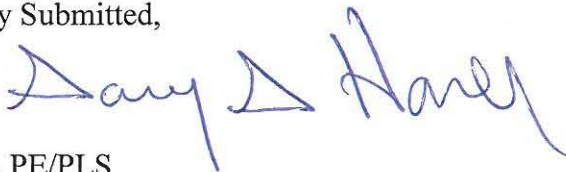
A handwritten signature in blue ink, reading "Gary Harer". The signature is stylized with a large "G" and "H".

Gary Harer, PE/PLS  
Municipal Services Director

WATER/SEWER  
RATE INCREASE HISTORY

1998	2.61%
1999	1.90%
2000	3.12%
2001	3.02%
2002	2.50%
2003	2.10%
2004	1.50%
2005	3.10%
2006	3.00%
2007	3.10%
2008	4.10%
2009	0.00%
2010	2.20%
2011	1.30%
2012	2.70% (proposed)

## Single Family Residence Rates

	Utility Rate for 3/4" Meter - Water	Utility Rate for 3/4" Meter - Sewer	Total Water & Sewer Fees for 2,000 cf	System Development Charges - Water	System Development Charges - Sewer	Total System Development Charges	Traffic Impact Fee	Parks Impact Fee	School Impact Fee	Total Impact Fees
	29.49 + \$3.55/cf over 1,200	\$30.16	\$88.05	\$750.00	N/A	\$750.00	N/A	N/A	N/A	\$0.00
Aberdeen	11.38/ \$1.39	\$31.26	\$56.54	\$2,055.00	\$308.00	\$2,363.00	N/A	N/A	N/A	\$0.00
Bremerton				\$9.00/ff \$900.00 max + water area chg .015sqft \$300.00 max + \$200.00 meter set	\$4,000.00 + .04/sqft of lot \$800.00 max + \$100.00 tap fee		N/A	N/A	N/A	\$0.00
Kennewick	7.5/\$0.85	\$40.58	\$65.08							
	\$8.05 + consumption chg per 100 cf \$1.48 - \$2.15	\$33.00	\$101.83	\$3,089.00	\$3,078.00	\$6,167.00	\$3,054.00	\$801.00	\$2,969.00	\$6,824.00
Olympia	\$12.50/\$0.65/100 cf	\$24.80	\$50.30	\$360.00	\$1,288.00	\$1,648.00	\$709.00	\$450.00	\$4,700.00	\$5,859.00
Pasco	\$21.75/\$2.09	\$30.15	\$85.17	\$1,295.00	\$1,386.00	\$2,681.00	N/A	N/A	N/A	\$0.00
Pullman				sm \$2,400/med \$3,610/lg \$5,030 + \$6,186 for any size	\$2,500.00 + \$425.09 permit & insp fee	\$5,325.09 based on small size	\$6,916.19	\$3,100.13		\$10,016.32
Redmond	\$12.85/\$1.55 - \$4.65	\$48.67	\$126.62	\$2,100.00	\$1,995.00	\$4,095.00	\$1,519.10	\$1,187.00	N/A	\$2,706.00
Richland	\$25/\$0.95	\$25.60	\$69.60	\$1,232.00	\$2,400.00	\$3,632.00	N/A	N/A	N/A	\$0.00
Spokane	\$9.25/\$0.26/100 CF	\$19.62	\$34.70							
	\$7.27/\$1.54/100 cf	\$36.15	\$74.22	\$2,360.00	\$2,740.00	\$5,100.00	formula used	formula used	\$1523 - \$6989	determined by project
Vancouver	\$37.30	\$45.90	\$96.70	per fixture fee base	per fixture fee base		N/A			\$0.00
Walla Walla	\$34.00/\$0.00	\$42.00	\$76.00	\$1,280.00	\$1,200.00	\$2,480.00		\$860.00		\$860.00
West Richland	\$15.91 + \$1.51/100 cf	\$18.99 + .6243/day	\$82.58	\$474.00	\$2,377.00	\$2,851.00	\$250.00			\$250.00
Yakima										
	\$21.65/\$0.81 over 500	\$33.20	\$66.00	\$1,059.00	\$374.00	\$1,433.00	N/A	N/A*	N/A	\$0.00
Moses Lake										

\*Fee in Lieu of Open Space Dedication - 5% of the assessed value as developed

July 9, 2012

TO: City Manager  
FROM: Assistant Finance Director  
SUBJECT: Gambling Tax Income Report



Attached is the Gambling Tax Report for the revenue received through the second quarter of 2012.

cc: Finance Director  
Parks and Recreation Director

Gambling Tax Revenue - Quarterly

Quarter Received	2008	2009	2010	2011	2012	YTD Change
Jan-Mar 1st Quarter	101,444.93	110,776.46	80,780.01	87,819.69	83,206.45	-5.25%
Apr-June 2nd Quarter	95,083.48	116,486.37	83,202.42	77,954.99	89,736.08	4.32%
July-Sept 3rd Quarter	104,549.97	92,109.39	76,570.12	70,340.10		
Oct-Dec 4th Quarter	69,260.04	79,458.35	76,381.22	69,284.37		
Totals	370,338.42	398,830.57	316,933.77	305,399.15	172,942.53	

July 10, 2012

TO: City Manager

FROM: Assistant Finance Director



SUBJECT: Investment Report

Attached is the Investment Report for the month of June, 2012.

cc: Finance Director  
Accounting Division Manager

Investment Report  
June, 2012

Investment With	Investment Type	Amount	Interest Rate	Purchase Date	Maturity Date	Interest Earned
Investments Outstanding						
Total Outstanding:		\$0.00				
Investment Maturities						
Grant County Invest Pool	Invest Acct	9,199,262.54	2.30	06/01/12	06/30/12	16,828.40
Wa. State Invest Pool	Invest Acct	9,976,321.94	0.14	06/01/12	06/30/12	1,431.93
Total Maturities:		19,175,584.48				
Investment Purchases						
Grant County Invest Pool	Invest Acct	9,216,090.94	2.35	07/01/12	07/31/12	
Wa. State Invest Pool	Invest Acct	10,037,342.99	0.17	07/01/12	07/31/12	
Total Purchases:		19,253,433.93				
Investment Totals						
Beginning Balance *		19,175,584.48				
Total Maturities		19,175,584.48				
Total Purchases		19,253,433.93				
Ending Balance *		19,253,433.93		Monthly Interest Earned		18,260.33

\* Beginning Balance = Total Outstanding +Total Maturities

\*Ending Balance = Beginning Balance - Total Maturities +Total Purchases



July 16, 2012

Honorable Mayor and  
Moses Lake City Council

Dear Council Members

Attached is sales tax information for April 2012 sales which the City received on June 30, 2012. This report indicates the City received \$399,414.06. The \$399,414.06 in receipts for June compares with June 2011 receipts of \$439,396.45. For the year, the 2012 receipts are approximately 4% lower than the 2011 receipts for the same period.

Also provided is the transient rental income report for income the City received on June 30, 2012. This report indicates May 2012 income (for April sales) of \$35,334.86. This compares with \$43,150.52 for the same period in 2011. For the year, transient rental income receipts are approximately 20% lower than the 2011 receipts for the same period.

Respectfully submitted

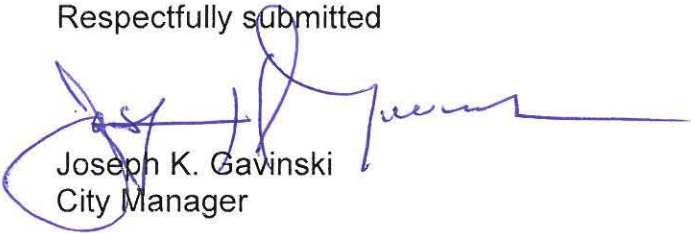

Joseph K. Gavinski  
City Manager

JKG:jt

July 9, 2012

TO: City Manager

FROM: Assistant Finance Director



SUBJECT: Sales Tax Receipts

Attached is the Sales Tax Receipts - Monthly Report for June, 2012.

cc: Finance Director  
Parks & Recreation Director

Sales Tax Receipts - Monthly

Month Received	Sales Period	2008	2009	2010	2011	2012	YTD Change
Jan	Nov	408,717.83	423,485.93	373,688.80	367,830.83	403,504.15	10%
Feb	Dec	469,332.60	575,401.82	560,731.77	488,453.72	459,218.16	1%
Mar	Jan	367,342.57	363,518.70	276,352.86	324,247.20	331,644.01	1%
Apr	Feb	385,196.04	346,570.37	330,932.86	368,305.65	350,818.56	-0%
May	Mar	495,704.60	425,086.28	402,951.97	456,738.86	405,657.25	-3%
June	Apr	432,257.32	428,915.48	384,565.04	439,396.45	399,414.06	-4%
July	May	522,411.98	421,462.37	380,216.47	431,750.56		
Aug	June	564,229.35	470,623.43	456,372.87	453,961.67		
Sept	July	527,800.54	409,860.53	407,935.17	411,796.14		
Oct	Aug	506,697.78	406,419.10	390,800.44	446,905.90		
Nov	Sept	509,888.34	447,607.52	438,011.36	411,689.43		
Dec	Oct	475,693.08	378,139.72	394,167.42	406,648.97		
Totals		5,665,272.03	5,097,091.25	4,796,727.03	5,007,725.38	2,350,256.19	

July 10, 2012

TO: City Manager  
FROM: Assistant Finance Director   
SUBJECT: Transient Rental Income Report

Attached are the Transient Rental Income reports for June, 2012.

cc: Finance Director  
Parks & Recreation Director

TRANSIENT RENTAL INCOME - MONTHLY TOTAL RECEIVED

MONTH RECEIVED	SALES PERIOD	2009	2010	2011	2012	YTD Change
JAN	NOV	48,677.30	24,816.04	39,728.66	25,073.90	-37%
FEB	DEC	26,992.76	20,136.24	25,155.98	26,277.18	-21%
MAR	JAN	31,765.70	27,491.94	30,274.86	28,091.94	-17%
APRIL	FEB	29,104.60	27,550.16	35,015.70	22,286.68	-22%
MAY	MAR	35,279.84	40,994.90	31,217.30	25,787.06	-21%
JUNE	APRIL	57,063.10	37,657.72	43,150.52	35,334.86	-20%
JULY	MAY	45,202.58	52,719.70	65,576.42		
AUGUST	JUNE	62,361.10	58,321.18	57,975.95		
SEPT	JULY	62,393.64	62,545.06	55,399.42		
OCT	AUGUST	58,102.10	61,950.36	62,457.58		
NOV	SEPT	48,046.92	46,504.36	56,261.04		
DEC	OCT	31,418.10	30,765.44	37,670.80		
TOTALS		536,407.74	491,453.10	539,884.23	162,851.62	